

Quick-Fit[®] and Flanged Ducting



2019 Price List

Effective September 2019



Made in
the USA



Ordering from Nordfab Ducting

This condensed price list contains pricing for many of Nordfab's standard products. Contact Nordfab or your Nordfab Authorized Dealer when you need pricing for duct in larger sizes, a gauge not shown here, or a customized product.

Nordfab manufactures duct in sizes up to 72" and gauges as thick as 10ga.

Pricing shown here is for uniform end types such as all ends QF or all ends Angle Flange. If you need parts with mixed connectors such as an Angle Flange on one end of a QF Branch, add the price of one Angle Flange to the needed QF Branch and be sure to specify that end is ANGFL when ordering.

Nordfab does not require part numbers for ordering. Just tell us what you need.

Examples:

Pipe Galv 14QF

Branch Galv 20QF 18QF 12QF

Reducer 304SS 12AFL 8AFL

Elbow Galv 14ga 8QF

Double Branch 10ga MS 72AFL 70AFL 62AFL 62AFL

Information Needed to Order Nordfab Products

REQUIRED for any Nordfab product					Product Dependent			
Product Name	Material Type	Material Thickness	Dimensions	End Type	Angle & Radius	Length	Control	Clamp Seal
<i>Examples:</i> Pipe Clamp Elbow Branch Hose Adapter Clear Rubber Hose Canopy Hood Ball Joint	<i>Examples:</i> Galvanized Steel Stainless Steel Mild Steel If you do not specify material, Nordfab will supply as standard Galvanized Steel, except for 10ga products which will be Mild Steel.	<i>Examples:</i> 20ga 16ga 14ga 10ga If you do not specify gauge, Nordfab will supply the product with our standard gauge material.	The A dimension is required. For Reducers, A and B are required. For Branches, A, B, and C are required. For Double Branches, specify A, B, C, and D. See our Branches section for other configurations.	<i>Examples:</i> QF AFL Hose Raw ID	Required for Elbows. Branch parts are supplied standard with a 30° angle. 45° can be supplied.	<i>Example:</i> 10ft Black Rubber Hose Nordfab hose is supplied in 5 foot increments.	Auto Diverter Valves and Blast Gates can be made with various AC or DC requirements. Blast Gates can be provided with single or double cylinders. Reed Switches are also available.	<i>Examples:</i> Nitrile Silicone ePTFE If you do not specify the seal, Nordfab will supply Nitrile as standard.

Galvanized Steel Material Thickness Options	Stainless Steel Material Thickness Options
22ga	22ga
20ga	20ga
18ga	18ga
16ga	16ga
14ga	-
12ga	-
10ga	-

End Type	Abbreviation
Quick-Fit	QF
No Fit	NF
Raw ID	RI
Raw OD	RO
Rawflex	RF
Angle Flange	AFL
Flat Flange	FFL
Vanstone	VS

Use this Price List with our Product Reference to specify and purchase Nordfab ductwork.

Type	Description	Page	Type	Description	Page	Type	Description	Page	Type	Description	Page
Pipe & Clamps			Adapters			Hoods			Accessories		
	QF Clamp	4		Reducer	14		Barrel Hood	18		No-Loss Stackhead	21
	QF Pipe & Flanged Pipe	4		Angle Flange Adapter	5		Bell Mouth Hood	18		Jet Cap	22
	Quick-Fit Sleeve & O-Ring	5		Machine Adapter	15		Canopy Hood	18		Silencer	22
	Quick-Fit Sleeve Assembly	5		Hose Adapter	15		Radial Arm Saw Hood	18		Suction Nozzle Assembly	22
	Angle Flange	5		Transition Rectangular to Round	14		Router Hood & Router Hood w/ Magnet	18		In Line Back Draft Damper	23
	Angle Flange Gasket	5		End Cap & End Cap with Bird Screen	15		Suction Hood	18		Ball Joint	21
Elbows				End Plate	15	Diverter Valves				Bleed-In Valve	22
	QF Elbow & Flanged Elbow	6-7	Blast Gates				Diverter Valve Manual	19		Butterfly Valve	22
	Elbows Long Radius	8-9		Blast Gate Manual	16		Diverter Valve Automatic	19		Viewing Spool	23
	Elbows Tubed	8		Blast Gate NFMS	16		SD Diverter Valve - Manual & Automatic	19		Sliding Access Panel	22
	Elbow Tubed Long Radius	9		Blast Gate Automatic NFES	16	Hangers & Installation				Floor Sweep	23
Branches				Blast Gate Automatic SD	16		Gripple Hanger	20		Drop Out Box	23
	Branch	11	Hoses & Clamps				Strut Hanger	20		Vibration Isolator	23
	Y-Branch	11		Rubber Hose, Black & Clear	17		Pipe Hanger	20	Special Applications		
	Double Branch	12		Static Dissipative Urethane Hose	17		Pipe Hanger HJ	20		In-line Spark Trap	21
	Tee Branch	12		Hose Clamp	17		Clamp Hanger	20		Leak-free Molded Gasket / Leak-Free Epoxy Caulking / Leak-free O-Ring	24
	In-Cut	13		Bridge Clamp (Hose)	17		Wall Flashing & Roof Flashing	21		Oil Mist Recycler / Drain Back for Hose	24
	Tap-In	13		Rigid Flex Steel & Ultra Flex Steel Hose	17		Roof Skirt	21			



Quick-Fit® Clamp with Pin

Ø in	QF Clamps with Nitrile Seals		QF Clamps with Silicone Seals		QF Clamps with ePTFE Seals	
	Galv. Price	304SS	Galv. Price	SS 304 Price Δ	Galv. Price	304SS
3	\$10.00 #	\$21.50 #	\$12.50 #	\$26.90 #	\$20.90 #	\$31.70 #
4	\$10.70 #	\$21.50 #	\$13.60 #	\$26.90 #	\$20.90 #	\$31.70 #
5	\$11.50 #	\$23.00 #	\$14.30 #	\$28.80 #	\$22.40 #	\$35.40 #
6	\$11.90 #	\$24.50 #	\$14.90 #	\$30.60 #	\$23.90 #	\$37.10 #
7	\$12.50 #	\$25.90 #	\$15.60 #	\$32.40 #	\$28.50 #	\$40.30 #
8	\$12.90 #	\$27.50 #	\$16.20 #	\$34.50 #	\$30.10 #	\$46.20 #
9	\$13.30 #	\$28.80 #	\$16.70 #	\$36.00 #	\$31.70 #	\$47.20 #
10	\$14.50 #	\$30.30 #	\$18.20 #	\$37.90 #	\$34.90 #	\$49.60 #
11	\$15.70 #	\$33.60 #	\$19.60 #	\$42.00 #	\$40.40 #	\$69.70 #
12	\$15.70 #	\$33.60 #	\$19.60 #	\$42.00 #	\$40.40 #	\$69.70 #
13	\$17.10 #	\$38.00 #	\$21.50 #	\$47.50 #	\$43.40 #	\$71.60 #
14	\$17.10 #	\$38.00 #	\$21.50 #	\$47.50 #	\$43.40 #	\$71.60 #
15	\$18.90 #	\$42.70 #	\$23.70 #	\$53.50 #	\$46.30 #	\$73.80 #
16	\$18.90 #	\$42.70 #	\$23.70 #	\$53.50 #	\$46.30 #	\$73.80 #
17	\$19.60 #	\$44.20 #	\$24.60 #	\$55.20 #	\$49.00 #	\$75.70 #
18	\$19.60 #	\$44.20 #	\$24.60 #	\$55.20 #	\$49.00 #	\$75.70 #
19	\$20.50 #	\$45.70 #	\$25.60 #	\$57.30 #	\$52.50 #	\$78.10 #
20	\$20.50 #	\$45.70 #	\$25.60 #	\$57.30 #	\$52.50 #	\$78.10 #
21	\$21.50 #	\$47.20 #	\$26.90 #	\$59.00 #	\$55.00 #	\$80.10 #
22	\$21.50 #	\$47.20 #	\$26.90 #	\$59.00 #	\$55.00 #	\$80.10 #
23	\$24.70 #	\$54.30 #	\$31.00 #	\$67.80 #	\$63.30 #	\$92.10 #
24	\$24.70 #	\$54.30 #	\$31.00 #	\$67.80 #	\$63.30 #	\$92.10 #

Additional Bridge Pins			
	Galv	304SS	
LARGE PINS	\$0.50	\$1.50	
	Galv	304SS	
SMALL PINS	\$0.20	\$0.50	
Additional Seals			
Ø in	Nitrile	Silicone	ePTFE
3 - 6	\$0.20 per foot	\$0.90 per foot	\$1.50 per foot
7 - 11	\$0.30 per foot	\$1.00 per foot	\$2.20 per foot
12 - 24	\$0.40 per foot	\$1.10 per foot	\$2.60 per foot



Pipe

Ø in	Ends	QF		18ga Galv	18ga 304SS	16ga Galv	16ga 304SS	14ga Galv	Ø in	Ends	Std Galv	Std 304SS	14ga Galv	12ga Galv
		Std Galv	Std 304SS	Std Galv	Std 304SS	Std Galv	Std 304SS	Std Galv			Std Galv	Std 304SS	Std Galv	Std 304SS
3		\$31.70 #	\$68.00 #						3		\$49.80	\$166.00		
4		\$31.70 #	\$68.00 #	\$41.10					4		\$67.20	\$166.00		
5		\$34.70 #	\$74.90 #	\$45.10					5		\$67.60	\$198.60		
6		\$41.80 #	\$86.90 #	\$54.30					6		\$74.20	\$203.50		
7		\$51.20 #	\$108.60 #	\$66.50					7		\$83.80	\$238.40		
8		\$57.50 #	\$115.80 #	\$74.90	\$150.54	\$80.60	\$162.12	\$103.50	8		\$93.10	\$240.70	\$112.90	
9		\$62.20 #	\$131.90 #	\$81.00	\$171.47	\$87.10	\$184.66	\$112.00	9		\$96.80	\$241.60	\$122.70	
10		\$66.90 #	\$144.20 #	\$87.10	\$187.46	\$94.00	\$201.88	\$120.40	10		\$111.80	\$272.60	\$132.50	\$152.60
11		\$80.20 #	\$171.90 #	\$104.40	\$223.47	\$112.30	\$240.66	\$144.40	11		\$130.30	\$323.20	\$156.20	\$180.30
12		\$80.20 #	\$171.90 #	\$104.40	\$223.47	\$112.30	\$240.66	\$144.40	12		\$130.30	\$323.20	\$166.20	\$190.30
13		\$103.30 #	\$218.80 #	\$134.40	\$284.44	\$144.70	\$306.32	\$186.00	13		\$147.20	\$364.20	\$205.90	\$237.00
14		\$103.30 #	\$218.80 #	\$134.40	\$284.44	\$144.70	\$306.32	\$186.00	14		\$147.20	\$364.20	\$209.20	\$240.20
15		\$134.10 #	\$268.80 #	\$174.30	\$349.44	\$187.70	\$376.32	\$241.40	15		\$206.50	\$416.70	\$259.30	\$299.60
16		\$134.10 #	\$268.80 #	\$174.30	\$349.44	\$187.70	\$376.32	\$241.40	16		\$206.50	\$416.70	\$287.00	\$327.20
17		\$147.80 #	\$322.20 #	\$192.20	\$418.86	\$207.00	\$451.08	\$266.20	17		\$214.70	\$579.00	\$312.60	\$356.90
18		\$147.80 #	\$322.20 #	\$192.20	\$418.86	\$207.00	\$451.08	\$266.20	18		\$214.70	\$579.00	\$315.50	\$359.90
19		\$177.40 #	\$386.00 #	\$230.80	\$501.80	\$248.10	\$540.40	\$319.30	20		\$265.40	\$579.60	\$371.80	\$425.00
20		\$177.40 #	\$386.00 #	\$230.80	\$501.80	\$248.10	\$540.40	\$319.30	22		\$289.90	\$626.90	\$407.70	\$466.60
21		\$196.30 #	\$430.30 #	\$255.10	\$559.39	\$274.90	\$602.42	\$353.20	24		\$312.20	\$721.60	\$457.40	\$525.10
22		\$196.30 #	\$430.30 #	\$255.10	\$559.39	\$274.90	\$602.42	\$353.20	26		\$333.00	\$1,020.40	\$458.70	\$521.70
23		\$225.80 #	\$494.80 #	\$293.60	\$643.24	\$316.30	\$692.72	\$406.40	28		\$361.40	\$1,027.50	\$498.70	\$567.30
24		\$225.80 #	\$494.80 #	\$293.60	\$643.24	\$316.30	\$692.72	\$406.40	30	AFL	\$416.10	\$1,122.30	\$580.60	\$662.70
									32		\$433.80	\$1,131.00	\$604.60	\$690.00
									34		\$481.80	\$1,137.00	\$675.80	\$773.00
									36		\$514.70	\$1,209.80	\$722.90	\$827.00
									38		\$569.40	\$1,334.80	\$741.90	\$846.30
									40		\$657.20	\$1,492.60	\$778.60	\$888.50
									42				\$863.80	\$987.90
									44				\$904.80	\$1,034.90
									46				\$944.50	\$1,080.40
									48				\$986.00	\$1,128.00
									50				\$1,026.30	\$1,174.00
									52				\$1,221.50	
									54				\$1,267.50	
									56				\$1,313.80	
									58				\$1,359.90	
									60				\$1,406.20	
									62				\$1,452.50	
									64				\$1,499.10	
									66				\$1,545.50	
									68				\$1,591.90	
									70				\$1,638.40	
									72				\$1,684.80	

#-Denotes an item that is returnable. See page 26 for a full listing of returnable items.



Quick-Fit® Sleeve with O-ring

Ø in	Ends	Std Galv	Std 304SS	18ga Galv
3		\$19.20 #	\$43.60 #	
4		\$19.20 #	\$43.60 #	\$25.00
5		\$19.60 #	\$44.90 #	\$25.60
6		\$20.20 #	\$47.40 #	\$26.10
7		\$24.20 #	\$55.70 #	\$31.70
8		\$24.70 #	\$56.90 #	\$32.00
9		\$26.00 #	\$58.90 #	\$34.00
10		\$26.50 #	\$61.40 #	\$34.40
11		\$30.30	\$70.60	\$39.50
12		\$30.30 #	\$70.60 #	\$39.50
13		\$41.00	\$96.10	\$53.50
14	QF	\$41.00 #	\$96.10 #	\$53.50
15		\$47.10	\$110.90	\$61.30
16		\$47.10 #	\$110.90 #	\$61.30
17		\$55.00	\$127.10	\$71.50
18		\$55.00 #	\$127.10 #	\$71.50
19		\$67.40	\$154.90	\$87.60
20		\$67.40 #	\$154.90 #	\$87.60
21		\$79.70	\$182.70	\$103.70
22		\$79.70 #	\$182.70 #	\$103.70
23		\$91.70	\$210.20	\$119.20
24		\$91.70 #	\$210.20 #	\$119.20



Quick-Fit Sleeve Assembly

Ø in	Ends	16ga Galv	14ga Galv
8		\$131.30	\$139.20
9		\$143.10	\$149.70
10		\$158.20	\$158.80
11		\$191.60	\$188.50
12		\$191.60	\$188.50
13		\$248.40	\$245.50
14		\$248.40	\$245.50
15		\$324.60	\$310.40
16	QF	\$324.60	\$310.40
17		\$354.40	\$346.30
18		\$354.40	\$346.30
19		\$408.00	\$417.40
20		\$408.00	\$417.40
21		\$454.80	\$468.70
22		\$454.80	\$468.70
23		\$512.60	\$539.10
24		\$512.60	\$539.10



O-ring

Ø in	Black Buna-N	Red Silicone
3	\$2.50 #	\$4.90 #
4	\$2.50 #	\$4.90 #
5	\$2.50 #	\$4.90 #
6	\$2.50 #	\$4.90 #
7	\$3.80 #	\$8.00 #
8	\$3.80 #	\$8.00 #
9	\$3.80 #	\$8.00 #
10	\$3.80 #	\$8.00 #
11	\$3.80 #	\$8.00 #
12	\$3.80 #	\$8.00 #
13	\$6.20 #	\$13.00 #
14	\$6.20 #	\$13.00 #
15	\$6.20 #	\$13.00 #
16	\$6.20 #	\$13.00 #
17	\$6.20 #	\$13.00 #
18	\$6.20 #	\$13.00 #
19	\$6.20 #	\$13.00 #
20	\$6.20 #	\$13.00 #
21	\$6.20 #	\$13.00 #
22	\$6.20 #	\$13.00 #
23	\$6.20 #	\$13.00 #
24	\$6.20 #	\$13.00 #



Angle Flange

Ø in	Galv	304SS	Ø In	Galv
3	\$10.60	\$49.80	50	\$197.10
4	\$10.60	\$49.80	52	\$205.60
5	\$11.70	\$52.90	54	\$212.50
6	\$14.60	\$55.70	56	\$220.60
7	\$15.60	\$59.70	58	\$229.60
8	\$19.30	\$61.50	60	\$237.00
9	\$21.50	\$61.60	62	\$239.20
10	\$25.60	\$63.30	64	\$245.90
11	\$33.50	\$66.40	66	\$253.10
12	\$33.50	\$66.40	68	\$260.30
13	\$41.60	\$70.10	70	\$267.50
14	\$41.60	\$70.10	72	\$274.70
15	\$56.70	\$84.30		
16	\$56.70	\$84.30		
17	\$59.90	\$111.00		
18	\$59.90	\$111.00		
19	\$62.90	\$120.30		
20	\$62.90	\$120.30		
21	\$70.10	\$132.70		
22	\$70.10	\$132.70		
23	\$75.20	\$155.50		
24	\$75.20	\$155.50		
25	\$104.70	\$208.30		
26	\$104.70	\$208.30		
27	\$115.30	\$211.60		
28	\$115.30	\$211.60		
29	\$126.20	\$215.00		
30	\$126.20	\$215.00		
31	\$132.50	\$219.50		
32	\$132.50	\$219.50		
33	\$143.10	\$222.30		
34	\$143.10	\$222.30		
35	\$147.50	\$226.50		
36	\$147.50	\$226.50		
37	\$149.70	\$270.80		
38	\$149.70	\$270.80		
39	\$160.40	\$302.10		
40	\$160.40	\$302.10		
42	\$164.90			
44	\$173.60			
46	\$181.50			
48	\$189.50			

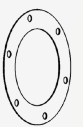

Angle Flange Gasket

Ø in	Nitrile	Silicone
3*	\$3.20	\$4.90
4	\$4.30	\$6.60
5*	\$5.40	\$8.20
6	\$6.80	\$10.10
7*	\$9.70	\$14.70
8	\$10.60	\$15.80
9*	\$11.60	\$17.50
10	\$16.60	\$24.90
11*	\$18.00	\$27.20
12	\$19.20	\$28.80
13*	\$22.70	\$34.10
14*	\$23.90	\$35.90
15*	\$33.50	\$50.30
16*	\$35.20	\$52.80
17*	\$37.10	\$55.70
18*	\$40.00	\$60.00
19*	\$41.70	\$62.60
20*	\$43.40	\$65.10
21**	\$66.20	\$99.30
22*	\$68.90	\$103.30
23**	\$71.50	\$107.30
24*	\$76.50	\$114.80
25**	\$79.10	\$118.80
26**	\$84.30	\$126.40
27**	\$87.00	\$130.50
28**	\$93.20	\$139.80
29**	\$93.20	\$139.80
30**	\$94.70	\$142.20
31**	\$97.40	\$146.20
32**	\$132.50	\$198.90
33**	\$136.00	\$204.20
34**	\$139.60	\$209.40
35**	\$143.00	\$214.50
36**	\$146.60	\$219.90
37**	\$150.00	\$225.10
38**	\$153.50	\$230.30
39**	\$156.90	\$235.40
40**	\$160.50	\$240.80
42**	\$163.90	\$254.10
44**	\$167.50	\$260.40
• 46**	\$171.10	\$266.60
• 48**	\$174.50	\$272.80

* Silicone Flange 5 - 7 days lead time
 ** Both Nitrile and Silicone are 5 - 7 days lead time.
 • Parts will be 4-piece segmented due to size.



Angle Flange Adapter

Ø in	Ends	Std Galv	Std SS 304	14ga Galv
3		\$50.30 #	\$89.00	
4		\$50.30 #	\$89.00	
5		\$52.90 #	\$99.00	
6		\$63.30 #	\$110.80	
7		\$68.40 #	\$119.00	
8		\$71.20 #	\$125.10	\$102.40
9		\$79.70	\$128.10	\$114.70
10		\$84.00	\$133.30	\$120.50
11		\$93.10	\$139.60	\$133.70
12		\$93.10	\$139.60	\$131.60
13	QF to AFL	\$97.10	\$151.00	\$136.90
14		\$97.10	\$151.00	\$136.30
15		\$105.60	\$163.30	\$148.90
16		\$105.60	\$163.30	\$143.00
17		\$114.50	\$203.20	\$155.60
18		\$114.50	\$203.20	\$154.90
19		\$121.70	\$216.50	\$164.10
20		\$121.70	\$216.50	\$164.10
21		\$130.30	\$232.80	\$175.60
22		\$130.30	\$232.80	\$175.60
23		\$149.80	\$267.80	\$204.30
24		\$149.80	\$267.80	\$204.30

#-Denotes an item that is returnable. See page 26 for a full listing of returnable items.



Elbow

90 Degree											
Ø in	Ends	Std Galv	Std 304SS	16ga Galv	16ga 304SS	14ga Galv	Ends	Std Galv	Std 304SS	14ga Galv	12ga Galv
3		\$46.40	TUBED					\$69.30	TUBED		
4		\$57.30 #	TUBED					\$82.40	TUBED		
5		\$63.50 #	TUBED					\$91.40	TUBED		
6		\$71.50 #	TUBED					\$110.00	TUBED		
7		\$95.40 #	\$297.40	\$188.10	\$404.70			\$132.50	\$437.70		
8		\$139.00 #	\$322.60	\$219.30	\$471.60	\$222.30		\$185.80	\$467.70	\$243.40	
9		\$144.30	\$336.10	\$228.00	\$490.30	\$231.00		\$196.10	\$482.40	\$254.10	
10		\$150.20 #	\$338.70	\$232.40	\$499.90	\$240.20		\$210.80	\$488.60	\$265.70	\$310.70
11		\$190.70	\$426.90	\$274.80	\$590.60	\$305.20		\$270.30	\$587.30	\$333.10	\$390.30
12		\$190.70 #	\$426.90	\$274.80	\$590.60	\$305.20		\$270.30	\$587.30	\$343.00	\$400.30
13		\$202.60	\$453.60	\$305.60	\$657.30	\$324.00		\$299.20	\$623.00	\$364.80	\$425.50
14		\$202.60 #	\$453.60	\$305.60	\$657.30	\$324.00		\$299.20	\$623.00	\$367.90	\$428.70
15		\$207.90	\$477.50	\$458.40	\$985.60	\$332.70		\$337.00	\$678.20	\$377.40	\$439.80
16		\$207.90 #	\$477.50	\$458.40	\$985.60	\$332.70		\$337.00	\$678.20	\$404.90	\$467.30
17		\$292.30	\$654.70	\$500.50	\$1,076.40	\$467.50		\$431.70	\$919.90	\$543.60	\$631.30
18		\$292.30 #	\$654.70	\$500.50	\$1,076.40	\$467.50		\$431.70	\$919.90	\$546.50	\$634.30
20	QF	\$341.00	\$764.10	\$717.60	\$1,543.10	\$545.60	AFL	\$489.20	\$1,054.20	\$633.40	\$735.70
22		\$438.70	\$985.50	\$779.50	\$1,676.10	\$701.90		\$606.20	\$1,311.10	\$795.50	\$927.00
24		\$504.40	\$1,133.30	\$896.40	\$1,927.50	\$807.10		\$697.10	\$1,507.70	\$903.30	\$1,054.50
26								\$807.60	\$1,611.10	\$1,218.10	\$1,423.40
28								\$992.00	\$1,940.00	\$1,507.60	\$1,765.40
30								\$1,017.40	\$2,007.50	\$1,542.50	\$1,805.10
32								\$1,280.60	\$2,074.20	\$1,959.60	\$2,299.10
34								\$1,460.50	\$2,469.90	\$2,241.70	\$2,632.30
36								\$1,663.40	\$3,026.80	\$2,560.80	\$3,009.60
38								\$1,897.80	\$3,649.20	\$2,769.20	\$3,253.60
40								\$2,293.30	\$4,538.10	\$2,980.90	\$3,503.80
42										\$3,219.40	\$3,748.30
44										\$3,340.20	\$3,926.70
46										\$3,490.60	\$4,103.80
48										\$3,642.70	\$4,282.60
50										\$3,793.60	\$4,460.20
60 Degree											
Ø in	Ends	Std Galv	Std 304SS	16ga Galv	16ga 304SS	14ga Galv	Ends	Std Galv	Std 304SS	14ga Galv	12ga Galv
3		\$46.40	TUBED					\$69.30	TUBED		
4		\$57.30 #	TUBED					\$82.40	TUBED		
5		\$59.50 #	TUBED					\$87.00	TUBED		
6		\$76.50 #	TUBED					\$110.00	TUBED		
7		\$95.40 #	\$221.60	\$135.00	\$290.20			\$132.50	\$358.50		
8		\$118.40	\$260.90	\$144.00	\$309.60	\$189.30		\$164.10	\$403.50	\$210.20	
9		\$121.50	\$271.90	\$170.60	\$366.70	\$194.50		\$172.20	\$415.30	\$217.70	
10		\$135.80	\$290.90	\$190.50	\$409.60	\$217.30		\$196.20	\$438.70	\$242.80	\$283.60
11		\$148.00	\$317.90	\$208.20	\$447.50	\$236.70		\$225.50	\$473.40	\$264.50	\$309.00
12		\$148.00	\$317.90	\$208.20	\$447.50	\$236.70		\$225.50	\$473.40	\$274.60	\$319.00
13		\$169.40	\$368.70	\$236.90	\$509.50	\$270.90		\$264.40	\$534.00	\$311.70	\$362.60
14		\$169.40	\$368.70	\$236.90	\$509.50	\$270.90		\$264.40	\$534.00	\$314.90	\$365.60
15		\$197.80	\$426.90	\$279.20	\$600.20	\$316.50		\$326.30	\$625.70	\$361.20	\$420.50
16		\$197.80	\$426.90	\$279.20	\$600.20	\$316.50		\$326.30	\$625.70	\$388.80	\$448.20
17		\$224.10	\$490.10	\$312.30	\$671.30	\$358.60		\$360.40	\$748.50	\$434.70	\$501.80
18		\$224.10 #	\$490.10	\$312.30	\$671.30	\$358.60		\$360.40	\$748.50	\$437.60	\$504.70
20	QF	\$288.50	\$616.90	\$398.80	\$857.30	\$461.70	AFL	\$434.40	\$900.60	\$549.60	\$636.00
22		\$341.00	\$733.70	\$465.20	\$1,000.30	\$545.60		\$504.10	\$1,048.70	\$639.30	\$741.60
24		\$392.10	\$843.60	\$534.90	\$1,150.20	\$627.50		\$579.60	\$1,205.90	\$723.60	\$841.20
26								\$620.40	\$1,228.10	\$918.90	\$1,068.10
28								\$703.70	\$1,392.40	\$1,046.40	\$1,217.70
30								\$819.10	\$1,620.80	\$1,225.20	\$1,428.30
32								\$1,003.50	\$1,985.90	\$1,516.30	\$1,772.60
34								\$1,249.30	\$2,122.70	\$1,903.70	\$2,231.00
36								\$1,529.60	\$2,205.20	\$2,201.90	\$2,583.30
38								\$1,871.00	\$3,109.20	\$2,381.50	\$2,793.40
40								\$2,162.80	\$4,279.80	\$2,562.80	\$3,007.20
42										\$2,740.40	\$3,216.40
44										\$2,870.80	\$3,369.40
46										\$2,999.80	\$3,521.20
48										\$3,130.80	\$3,674.70
50										\$3,260.30	\$3,826.90

#-Denotes an item that is returnable. See page 26 for a full listing of returnable items.



Elbow

Ø in	45 Degree						Ends	Std Galv	Std 304SS	14ga Galv	12ga Galv
	Std Galv	Std 304SS	16ga Galv	16ga 304SS	14ga Galv						
3	\$41.90	TUBED					\$47.40	TUBED			
4	\$48.90 #	TUBED					\$73.80	TUBED			
5	\$54.10 #	TUBED					\$81.40	TUBED			
6	\$64.30 #	TUBED					\$97.90	TUBED			
7	\$90.60 #	\$192.70	\$128.50	\$276.20			\$127.60	\$328.60			
8	\$97.90	\$197.60	\$139.40	\$299.90	\$156.60		\$142.80	\$337.40	\$177.60		
9	\$99.70	\$205.60	\$144.00	\$309.60	\$159.70		\$149.30	\$346.20	\$182.80		
10	\$103.90	\$218.00	\$148.40	\$318.90	\$166.30		\$162.80	\$362.70	\$191.80	\$223.10	
11	\$109.80	\$237.10	\$155.20	\$333.50	\$175.60		\$185.50	\$389.10	\$203.50	\$236.40	
12	\$109.80	\$237.10	\$155.20	\$333.50	\$175.60		\$185.50	\$389.10	\$213.50	\$246.40	
13	\$118.40	\$253.90	\$168.30	\$361.70	\$189.30		\$210.80	\$414.50	\$230.00	\$265.60	
14	\$118.40	\$253.90	\$168.30	\$361.70	\$189.30		\$210.80	\$414.50	\$233.20	\$268.60	
15	\$158.70	\$342.40	\$219.30	\$471.60	\$253.90		\$285.40	\$537.30	\$298.50	\$346.10	
16	\$158.70	\$342.40	\$219.30	\$471.60	\$253.90		\$285.40	\$537.30	\$326.20	\$373.80	
17	\$182.60	\$396.90	\$256.90	\$552.30	\$292.20		\$317.00	\$651.20	\$368.10	\$422.80	
18	\$182.60	\$396.90	\$256.90	\$552.30	\$292.20		\$317.00	\$651.20	\$371.10	\$425.90	
20	\$218.20	\$469.70	\$299.00	\$643.00	\$349.30	AFL	\$361.30	\$747.10	\$437.00	\$502.60	
22	\$250.40	\$537.70	\$338.80	\$728.70	\$400.70		\$409.60	\$844.10	\$494.30	\$569.50	
24	\$288.10	\$618.30	\$389.80	\$837.90	\$460.90		\$471.00	\$970.90	\$556.90	\$643.40	
26							\$567.60	\$1,123.00	\$834.10	\$967.40	
28							\$700.20	\$1,383.30	\$1,040.80	\$1,211.10	
30							\$749.80	\$1,483.80	\$1,114.60	\$1,296.90	
32							\$830.50	\$1,643.80	\$1,239.40	\$1,443.80	
34							\$890.40	\$1,762.30	\$1,329.50	\$1,548.90	
36							\$987.40	\$1,956.40	\$1,479.20	\$1,725.00	
38							\$1,095.90	\$2,168.50	\$1,606.20	\$1,872.70	
40							\$1,218.00	\$2,410.80	\$1,726.30	\$2,013.90	
42									\$1,844.50	\$2,152.50	
44									\$1,932.20	\$2,254.80	
46									\$2,018.60	\$2,356.00	
48									\$2,106.90	\$2,458.80	
50									\$2,193.70	\$2,560.40	
30 Degree											
3	\$41.90	TUBED					\$73.80	TUBED			
4	\$48.90 #	TUBED					\$73.80	TUBED			
5	\$54.10 #	TUBED					\$81.40	TUBED			
6	\$66.70 #	TUBED					\$100.50	TUBED			
7	\$90.60 #	\$164.30	\$124.00	\$266.70			\$127.60	\$298.70			
8	\$92.10	\$174.00	\$130.70	\$281.00	\$147.30		\$136.80	\$312.80	\$168.40		
9	\$95.40	\$178.70	\$135.00	\$290.20	\$152.60		\$144.80	\$318.30	\$175.80		
10	\$99.70	\$182.60	\$139.40	\$299.90	\$159.70		\$158.30	\$325.50	\$185.20	\$215.00	
11	\$101.90	\$191.80	\$144.00	\$309.60	\$163.00		\$177.30	\$342.00	\$190.90	\$221.40	
12	\$101.90	\$191.80	\$144.00	\$309.60	\$163.00		\$177.30	\$342.00	\$200.80	\$231.40	
13	\$112.50	\$194.80	\$157.20	\$338.10	\$180.00		\$205.40	\$352.60	\$220.80	\$254.50	
14	\$112.50	\$194.80	\$157.20	\$338.10	\$180.00		\$205.40	\$352.60	\$223.90	\$257.80	
15	\$125.60	\$260.30	\$177.20	\$381.10	\$200.90		\$251.10	\$451.60	\$245.60	\$283.40	
16	\$125.60	\$260.30	\$177.20	\$381.10	\$200.90		\$251.10	\$451.60	\$273.30	\$311.10	
17	\$136.50	\$297.10	\$192.70	\$414.30	\$218.30		\$269.30	\$546.80	\$294.30	\$335.20	
18	\$136.50	\$297.10	\$192.70	\$414.30	\$218.30		\$269.30	\$546.80	\$297.30	\$338.20	
20	\$159.70	\$345.50	\$210.50	\$452.40	\$255.50	AFL	\$300.10	\$617.60	\$343.50	\$391.50	
22	\$182.60	\$393.70	\$256.90	\$552.30	\$292.20		\$338.70	\$693.70	\$385.80	\$440.50	
24	\$209.90	\$452.90	\$295.40	\$635.30	\$336.00		\$389.50	\$797.70	\$432.00	\$495.00	
26							\$505.50	\$999.80	\$734.80	\$849.40	
28							\$554.90	\$1,095.60	\$808.10	\$934.70	
30							\$620.40	\$1,228.10	\$907.60	\$1,051.00	
32							\$647.10	\$1,278.20	\$946.10	\$1,095.40	
34							\$747.60	\$1,479.20	\$1,101.10	\$1,277.70	
36							\$821.20	\$1,625.30	\$1,213.40	\$1,409.40	
38							\$903.30	\$1,785.20	\$1,322.00	\$1,535.20	
40							\$993.30	\$1,963.20	\$1,419.60	\$1,649.60	
42									\$1,516.10	\$1,762.40	
44									\$1,588.10	\$1,846.20	
46									\$1,658.90	\$1,928.70	
48									\$1,731.30	\$2,013.00	
50									\$1,802.70	\$2,096.00	

#-Denotes an item that is returnable. See page 26 for a full listing of returnable items.

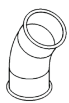

Elbow Tubed

90 Degree			
Ø in	Ends	Std Galv	Std 304SS
3		\$69.80	\$110.90
4		\$69.80	\$113.90
5	QF	\$132.60	\$229.70
6		\$178.00	\$280.40
8	◆	\$350.50	\$531.40
60 Degree			
3		\$69.80	\$110.90
4		\$69.80	\$113.90
5	QF	\$132.60	\$229.70
6		\$178.00	\$280.40
8	◆	\$350.50	\$531.40
45 Degree			
3		\$69.80	\$110.90
4		\$69.80	\$113.90
5	QF	\$132.60	\$229.70
6		\$178.00	\$280.40
8	◆	\$350.50	\$531.40
30 Degree			
3		\$69.80	\$110.90
4		\$69.80	\$113.90
5	QF	\$132.60	\$229.70
6		\$178.00	\$280.40
8	◆	\$350.50	\$531.40

◆ Items may take longer than standard lead times.



Elbow Long Radius

90 Degree										
Ø in	Ends	Std Galv	Std 304SS	14ga Galv	Ends	Std Galv	Std 304SS	14ga Galv	12ga Galv	
3		\$46.40	TUBED							
4		\$61.80 #	TUBED							
5		\$69.30 #	TUBED							
6		\$76.00 #	TUBED							
7		\$101.90 #	\$347.90							
8		\$180.00	\$387.30	\$288.10		\$231.00	\$535.40	\$309.00		
9		\$187.30	\$403.40	\$299.60		\$240.70	\$552.60	\$322.80		
10		\$190.70	\$409.40	\$305.20		\$253.20	\$562.40	\$330.60		\$387.90
11		\$225.50	\$480.70	\$360.70		\$306.20	\$643.20	\$388.50		\$456.20
12		\$225.50	\$480.70	\$360.70		\$306.20	\$643.20	\$398.60		\$466.20
13		\$250.40	\$535.80	\$400.70		\$348.80	\$708.60	\$441.40		\$516.60
14		\$250.40	\$535.80	\$400.70		\$348.80	\$708.60	\$444.60		\$519.70
15		\$391.00	\$841.30	\$625.70		\$528.00	\$1,057.70	\$670.40		\$787.70
16		\$391.00	\$841.30	\$625.70		\$528.00	\$1,057.70	\$698.10		\$815.30
17		\$426.90	\$919.00	\$683.20		\$572.10	\$1,195.80	\$759.20		\$887.20
18		\$426.90	\$919.00	\$683.20		\$572.10	\$1,195.80	\$762.10		\$890.20
20	QF	\$708.20	\$988.30	\$1,133.10	AFL	\$872.40	\$1,288.20	\$1,221.00		\$1,433.40
22		\$721.30	\$1,249.30	\$1,154.10		\$901.00	\$1,586.70	\$1,248.00		\$1,464.30
24		\$829.80	\$1,436.80	\$1,327.50		\$1,036.10	\$1,824.50	\$1,423.60		\$1,672.50
26						\$1,009.40	\$2,014.20	\$1,541.00		\$1,807.00
28						\$1,240.00	\$2,425.00	\$1,904.40		\$2,236.60
30						\$1,271.70	\$2,509.30	\$1,949.50		\$2,288.40
32						\$1,600.60	\$2,592.90	\$2,471.60		\$2,906.90
34						\$1,825.60	\$3,087.40	\$2,825.90		\$3,326.10
36						\$2,079.10	\$3,783.70	\$3,225.90		\$3,799.30
38						\$2,371.90	\$4,628.20	\$3,684.10		\$4,340.20
40						\$2,866.60	\$5,672.60	\$4,106.70		\$4,840.60
42								\$4,479.70		\$5,281.90
44								\$4,693.10		\$5,533.30
46								\$4,905.00		\$5,783.40
48								\$5,118.60		\$6,035.30
50								\$5,331.00		\$6,285.90
60 Degree										
3		\$46.40	TUBED							
4		\$61.80	TUBED							
5		\$69.30	TUBED							
6		\$76.00	TUBED							
7		\$100.10	\$309.90							
8		\$140.50	\$321.80	\$224.70		\$187.30	\$465.90	\$245.50		
9		\$149.30	\$333.60	\$238.90		\$201.20	\$480.10	\$262.00		
10		\$166.90	\$356.70	\$266.90		\$228.30	\$507.60	\$292.40		\$342.40
11		\$181.50	\$390.40	\$290.30		\$260.40	\$548.90	\$318.30		\$372.70
12		\$181.50	\$390.40	\$290.30		\$260.40	\$548.90	\$328.20		\$382.70
13		\$207.80	\$452.30	\$332.40		\$304.80	\$621.60	\$373.20		\$435.50
14		\$207.80	\$452.30	\$332.40		\$304.80	\$621.60	\$376.40		\$438.80
15		\$243.00	\$524.20	\$388.80		\$373.50	\$726.70	\$433.50		\$506.40
16		\$243.00	\$524.20	\$388.80		\$373.50	\$726.70	\$461.10		\$533.90
17		\$275.00	\$601.70	\$440.10		\$413.70	\$864.70	\$516.10		\$598.70
18		\$275.00	\$601.70	\$440.10		\$413.70	\$864.70	\$519.10		\$601.50
20	QF	\$354.40	\$756.90	\$566.90	AFL	\$503.00	\$1,046.70	\$654.80		\$761.10
22		\$418.50	\$900.30	\$669.60		\$585.10	\$1,222.60	\$763.30		\$888.80
24		\$481.40	\$1,035.30	\$770.20		\$672.60	\$1,405.70	\$866.40		\$1,010.70
26						\$775.70	\$1,535.30	\$1,167.10		\$1,362.90
28						\$879.60	\$1,740.40	\$1,327.70		\$1,551.80
30						\$1,023.70	\$2,025.80	\$1,552.70		\$1,817.30
32						\$1,254.50	\$2,482.40	\$1,917.60		\$2,249.30
34						\$1,561.70	\$2,653.20	\$2,403.70		\$2,824.70
36						\$1,912.20	\$2,756.60	\$2,767.20		\$3,254.70
38						\$2,338.70	\$4,561.30	\$3,159.20		\$3,717.00
40						\$2,703.50	\$5,349.80	\$3,519.70		\$4,143.40
42								\$3,838.20		\$4,519.90
44								\$4,020.80		\$4,734.90
46								\$4,202.10		\$4,948.80
48								\$4,385.20		\$5,164.40
50								\$4,567.10		\$5,378.70

#-Denotes an item that is returnable. See page 26 for a full listing of returnable items.



Elbow Long Radius

45 Degree									
Ø in	Ends	Std Galv	Std 304SS	14ga Galv	Ends	Std Galv	Std 304SS	14ga Galv	12ga Galv
3		\$41.90	TUBED						
4		\$61.80	TUBED						
5		\$69.30	TUBED						
6		\$76.00	TUBED						
7		\$125.90	\$271.90						
8		\$140.50	\$302.80	\$224.70		\$187.30	\$467.30	\$245.50	
9		\$149.30	\$333.60	\$238.90		\$201.20	\$480.10	\$262.00	
10		\$166.90	\$356.70	\$266.90		\$228.30	\$507.60	\$292.40	\$342.40
11		\$181.50	\$390.40	\$290.30		\$260.40	\$548.90	\$318.30	\$372.70
12		\$181.50	\$390.40	\$290.30		\$260.40	\$548.90	\$328.20	\$382.70
13		\$207.80	\$452.30	\$332.40		\$304.80	\$621.40	\$373.20	\$435.50
14		\$207.80	\$452.30	\$332.40		\$304.80	\$621.40	\$376.40	\$438.80
15		\$243.00	\$524.20	\$388.80		\$373.50	\$726.70	\$433.50	\$506.40
16		\$243.00	\$524.20	\$388.80		\$373.50	\$726.70	\$461.10	\$533.90
17		\$275.00	\$601.70	\$440.10		\$413.70	\$864.70	\$516.10	\$598.70
18		\$275.00	\$601.70	\$440.10		\$413.70	\$864.70	\$519.10	\$601.50
20	QF	\$354.40	\$756.90	\$566.90	AFL	\$503.00	\$1,046.70	\$654.80	\$761.10
22		\$418.50	\$900.30	\$669.60		\$585.10	\$1,222.60	\$763.30	\$888.80
24		\$481.40	\$1,035.30	\$770.20		\$672.60	\$1,405.70	\$866.40	\$1,010.70
26						\$709.60	\$1,404.00	\$1,061.30	\$1,237.10
28						\$875.40	\$1,729.30	\$1,321.00	\$1,543.70
30						\$937.20	\$1,854.70	\$1,414.30	\$1,652.90
32						\$1,038.30	\$2,054.40	\$1,571.90	\$1,838.70
34						\$1,113.10	\$2,202.80	\$1,686.00	\$1,972.30
36						\$1,234.20	\$2,445.60	\$1,849.70	\$2,165.10
38						\$1,369.80	\$2,710.90	\$2,109.50	\$2,470.30
40						\$1,522.50	\$3,013.50	\$2,345.60	\$2,749.20
42								\$2,554.70	\$2,995.90
44								\$2,676.40	\$3,138.60
46								\$2,796.60	\$3,279.60
48								\$2,918.50	\$3,422.70
50								\$3,039.30	\$3,564.50

30 Degree									
Ø in	Ends	Std Galv	Std 304SS	14ga Galv	Ends	Std Galv	Std 304SS	14ga Galv	12ga Galv
3		\$45.40	TUBED						
4		\$61.80	TUBED						
5		\$69.30	TUBED						
6		\$76.00	TUBED						
7		\$94.40	\$201.70						
8		\$109.20	\$210.40	\$174.50		\$154.70	\$354.40	\$195.40	
9		\$115.00	\$219.30	\$183.90		\$165.10	\$360.50	\$207.10	
10		\$119.20	\$223.90	\$190.90		\$178.70	\$368.90	\$216.30	\$252.20
11		\$127.90	\$235.30	\$204.60		\$204.50	\$387.30	\$232.50	\$270.90
12		\$127.90	\$235.30	\$204.60		\$204.50	\$387.30	\$242.60	\$280.90
13		\$136.50	\$238.80	\$218.30		\$230.20	\$398.70	\$259.00	\$299.90
14		\$136.50	\$238.80	\$218.30		\$230.20	\$398.70	\$262.20	\$303.10
15		\$149.60	\$319.50	\$239.20		\$275.90	\$513.30	\$283.90	\$328.90
16		\$149.60	\$319.50	\$239.20		\$275.90	\$513.30	\$311.60	\$356.40
17		\$167.60	\$364.70	\$268.10		\$301.50	\$617.30	\$344.10	\$394.40
18		\$167.60	\$364.70	\$268.10		\$301.50	\$617.30	\$347.10	\$397.30
20	QF	\$196.30	\$424.00	\$314.10	AFL	\$338.00	\$699.30	\$401.90	\$460.90
22		\$223.70	\$483.20	\$357.90		\$382.00	\$787.20	\$451.80	\$518.80
24		\$257.30	\$555.50	\$411.60		\$439.40	\$905.30	\$507.70	\$584.80
26						\$631.60	\$1,249.80	\$936.60	\$1,089.10
28						\$693.50	\$1,369.60	\$1,030.10	\$1,198.30
30						\$775.70	\$1,535.30	\$1,155.90	\$1,345.90
32						\$808.90	\$1,597.90	\$1,204.80	\$1,402.60
34						\$934.40	\$1,849.10	\$1,400.00	\$1,632.80
36						\$1,026.60	\$2,031.80	\$1,513.20	\$1,765.60
38						\$1,128.90	\$2,231.40	\$1,724.60	\$2,013.30
40						\$1,241.60	\$2,454.00	\$1,914.90	\$2,237.90
42								\$2,084.30	\$2,437.10
44								\$2,183.30	\$2,553.10
46								\$2,281.20	\$2,667.70
48								\$2,380.80	\$2,784.10
50								\$2,479.10	\$2,899.30



Elbow Tubed Long Radius

90 Degree			
Ø in	Ends	Std Galv	Std 304SS
3		\$76.00	\$155.30
4		\$76.00	\$206.90
5	QF	\$132.60	\$353.30
6		\$182.20	\$425.30
8	◆	\$346.00	\$736.10
60 Degree			
3		\$76.00	\$155.30
4		\$76.00	\$206.90
5	QF	\$132.60	\$353.30
6		\$182.20	\$425.30
8	◆	\$346.00	\$736.10
45 Degree			
3		\$76.00	\$155.30
4		\$76.00	\$155.30
5	QF	\$132.60	\$265.20
6		\$182.20	\$318.90
8	◆	\$346.00	\$552.20
30 Degree			
3		\$76.00	\$155.30
4		\$76.00	\$155.30
5	QF	\$132.60	\$265.20
6		\$182.20	\$318.90
8	◆	\$346.00	\$552.20

◆ Items may take longer than standard lead times.

New Branch End Labels Effective Sept. 2019

Example of Standard Branch Part Number Change

If ordering prior to September 2019, a Standard Branch with these current end dimensions:

A=23 B=16 C=19

Part no. would be 3220-2316-11900

3220-2316-119000 is the **Nordfab Legacy Number** for this product.

You may order using Legacy Part Numbers.

New part number is 8040004807 and new description is:

Branch Std Galv 20ga 23QF 19QF 16QF 30Deg

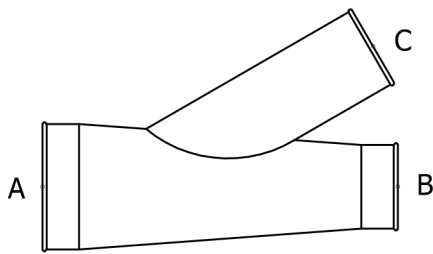
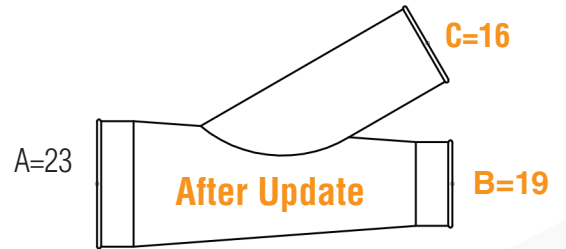
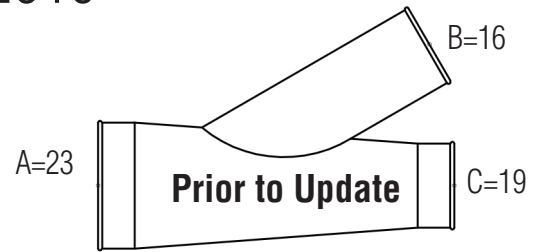

STD. BRANCH

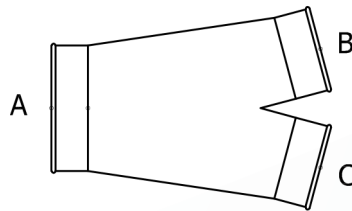

Y BRANCH

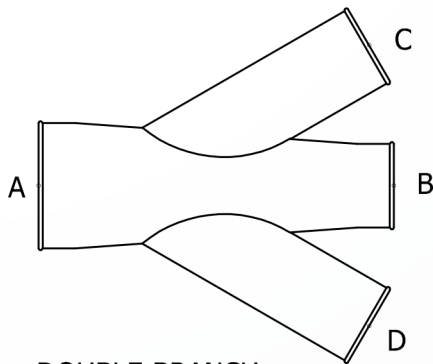

DOUBLE BRANCH

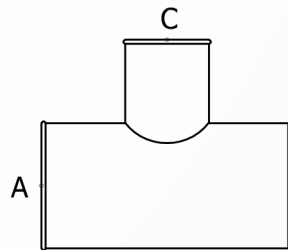

TEE BRANCH

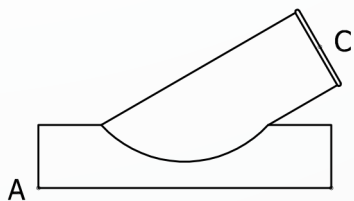

IN CUT

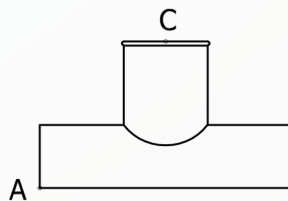

TAP IN

IMPORTANT:

When ordering all branch parts, double-check that you have considered these changes in the end designations.

New designations are shown here.



Branch

		30° Standard 45° Optional							
Ø in	Ends	Std Galv	Std 304SS	14ga Galv	Ends	Std Galv	Std 304SS	14ga Galv	12ga Galv
3		\$128.00	\$266.20						
4		\$128.00	\$266.20						
5		\$134.80	\$271.40						
6		\$139.30	\$277.30						
7		\$141.50	\$283.30						
8		\$144.80	\$291.10	\$217.30				\$248.70	
9		\$151.60	\$302.40	\$227.30				\$262.10	
10		\$161.70	\$321.80	\$242.60				\$280.70	\$329.20
11		\$179.70	\$359.90	\$269.60				\$311.30	\$365.20
12		\$179.70	\$359.90	\$269.60				\$326.30	\$380.20
13		\$210.80	\$423.90	\$316.40				\$377.50	\$440.70
14		\$210.80	\$423.90	\$316.40				\$382.20	\$445.50
15		\$242.70	\$487.60	\$363.90				\$431.00	\$503.80
16		\$242.70	\$487.60	\$363.90				\$472.40	\$545.20
17		\$264.00	\$531.90	\$396.00				\$510.10	\$589.20
18		\$264.00	\$531.90	\$396.00				\$514.50	\$593.60
20	QF	\$317.80	\$632.90	\$476.70	AFL			\$608.60	\$703.90
22		\$399.70	\$796.60	\$599.60				\$740.10	\$860.00
24		\$459.60	\$916.10	\$689.50				\$833.60	\$971.50
26						\$507.60	\$1,100.60	\$853.80	\$987.60
28						\$649.00	\$1,195.00	\$1,073.10	\$1,248.00
30						\$729.90	\$1,304.60	\$1,201.30	\$1,399.10
32						\$817.40	\$1,364.80	\$1,337.90	\$1,560.90
34						\$909.60	\$1,453.20	\$1,483.20	\$1,732.30
36						\$1,001.70	\$1,497.40	\$1,628.40	\$1,903.70
38						\$1,102.60	\$1,615.60	\$1,792.60	\$2,095.70
40						\$1,210.50	\$1,704.10	\$1,926.50	\$2,254.00
42								\$2,005.50	\$2,346.00
44								\$2,100.80	\$2,457.50
46								\$2,194.20	\$2,567.10
48								\$2,290.20	\$2,679.40
50								\$2,384.40	\$2,789.70

NOTE: See page 26 for returnable sizes



Y Branch

		60° Standard 90° Optional							
Ø in	Ends	Std Galv	Std 304SS	14ga Galv	Ends	Std Galv	Std 304SS	14ga Galv	12ga Galv
3		\$164.60	\$340.70						
4		\$164.60	\$340.70						
5		\$173.50	\$345.20						
6		\$180.80	\$360.20						
7		\$186.10	\$372.50						
8		\$194.30	\$386.80	\$291.50				\$323.00	
9		\$204.30	\$405.90	\$306.50				\$341.20	
10		\$208.20	\$417.50	\$312.20				\$350.50	\$412.80
11		\$239.10	\$475.80	\$358.70				\$400.50	\$472.20
12		\$239.10	\$475.80	\$358.70				\$415.40	\$487.30
13		\$287.90	\$572.70	\$431.70				\$492.80	\$579.10
14		\$287.90	\$572.70	\$431.70				\$497.60	\$583.80
15		\$320.20	\$638.00	\$480.30				\$547.40	\$643.40
16		\$320.20	\$638.00	\$480.30				\$588.70	\$684.90
17		\$355.70	\$707.20	\$533.50				\$647.50	\$754.20
18		\$355.70	\$707.20	\$533.50				\$652.00	\$758.60
20	QF	\$423.20	\$842.20	\$634.70	AFL			\$766.60	\$893.60
22		\$486.10	\$969.70	\$729.10				\$869.70	\$1,015.50
24		\$559.20	\$1,115.20	\$838.90				\$983.00	\$1,150.80
26						\$642.90	\$1,193.30	\$1,056.70	\$1,231.00
28						\$738.70	\$1,283.40	\$1,207.50	\$1,409.20
30						\$812.10	\$1,366.00	\$1,324.70	\$1,547.00
32						\$894.40	\$1,448.60	\$1,453.20	\$1,699.20
34						\$985.90	\$1,516.10	\$1,597.70	\$1,869.70
36						\$1,079.60	\$1,651.20	\$1,745.00	\$2,043.70
38						\$1,191.80	\$1,793.70	\$1,910.00	\$2,236.70
40						\$1,310.80	\$1,913.80	\$2,067.00	\$2,422.60
42								\$2,172.00	\$2,545.70
44								\$2,275.20	\$2,666.90
46								\$2,376.50	\$2,785.50
48								\$2,480.50	\$2,907.80
50								\$2,582.50	\$3,027.60



Double Branch

Ø in	Ends	30° Standard			45° Optional				
		Std Galv	Std 304SS	14ga Galv	Ends	Std Galv	Std 304SS	14ga Galv	12ga Galv
3		\$163.80	\$339.30						
4		\$163.80	\$339.30						
5		\$172.60	\$343.60						
6		\$180.00	\$358.70						
7		\$185.20	\$370.70						
8		\$193.60	\$385.10	\$290.20			\$332.20		
9		\$203.20	\$404.20	\$304.90			\$351.10		
10		\$207.30	\$415.70	\$311.00			\$361.80	\$424.00	
11		\$237.80	\$473.80	\$356.90			\$412.60	\$484.00	
12		\$237.80	\$473.80	\$356.90			\$432.60	\$504.00	
13		\$286.40	\$570.30	\$429.80			\$511.10	\$597.10	
14		\$286.40	\$570.30	\$429.80			\$517.40	\$603.50	
15		\$318.70	\$635.30	\$477.90			\$567.30	\$662.90	
16		\$318.70	\$635.30	\$477.90			\$622.60	\$718.20	
17		\$354.10	\$704.20	\$531.10			\$683.20	\$789.30	
18		\$354.10	\$704.20	\$531.10			\$689.10	\$795.30	
20	QF	\$421.30	\$838.40	\$631.80	AFL		\$807.70	\$934.10	
22		\$483.90	\$965.50	\$725.90			\$913.20	\$1,058.40	
24		\$556.50	\$1,110.50	\$834.70			\$1,026.80	\$1,193.80	
26						\$639.80	\$1,188.10	\$1,113.60	\$1,287.10
28						\$735.30	\$1,277.90	\$1,268.80	\$1,469.40
30						\$808.30	\$1,360.20	\$1,390.00	\$1,611.20
32						\$890.40	\$1,442.40	\$1,521.80	\$1,766.50
34						\$981.60	\$1,509.30	\$1,670.60	\$1,941.20
36						\$1,074.80	\$1,644.10	\$1,821.70	\$2,118.90
38						\$1,186.30	\$1,786.10	\$1,944.50	\$2,259.50
40						\$1,304.70	\$1,905.60	\$2,043.30	\$2,374.80
42								\$2,144.30	\$2,492.40
44								\$2,246.30	\$2,610.90
46								\$2,345.40	\$2,726.70
48								\$2,448.30	\$2,846.20
50								\$2,548.60	\$2,963.00



Tee Branch

Ø in	Ends	30° Standard			45° Optional				
		Std Galv	Std 304SS	14ga Galv	Ends	Std Galv	Std 304SS	14ga Galv	12ga Galv
3		\$130.00	\$269.60						
4		\$130.00	\$269.60						
5		\$136.60	\$274.80						
6		\$141.20	\$281.00						
7		\$143.40	\$287.10						
8		\$147.00	\$295.30	\$220.50			\$251.90		
9		\$153.60	\$306.50	\$230.40			\$265.20		
10		\$163.80	\$325.90	\$245.70			\$283.90	\$333.10	
11		\$182.10	\$364.70	\$273.10			\$314.90	\$369.60	
12		\$182.10	\$364.70	\$273.10			\$329.90	\$384.50	
13		\$213.90	\$430.10	\$320.90			\$382.00	\$446.20	
14		\$213.90	\$430.10	\$320.90			\$386.70	\$450.90	
15		\$246.00	\$493.90	\$369.00			\$436.00	\$509.80	
16		\$246.00	\$493.90	\$369.00			\$477.40	\$551.20	
17		\$267.60	\$538.90	\$401.40			\$515.40	\$595.70	
18		\$267.60	\$538.90	\$401.40			\$519.90	\$600.20	
20	QF	\$322.20	\$640.80	\$483.40	AFL		\$615.30	\$711.90	
22		\$405.20	\$807.00	\$607.90			\$748.40	\$870.00	
24		\$466.10	\$928.10	\$699.20			\$843.30	\$983.20	
26						\$514.70	\$1,323.30	\$864.40	\$1,000.30
28						\$658.10	\$1,420.80	\$1,086.60	\$1,264.10
30						\$740.00	\$1,536.80	\$1,216.50	\$1,417.20
32						\$828.80	\$1,602.10	\$1,355.10	\$1,581.40
34						\$922.10	\$1,694.60	\$1,502.20	\$1,755.10
36						\$1,015.60	\$1,743.50	\$1,649.20	\$1,928.80
38						\$1,118.00	\$1,907.40	\$1,815.70	\$2,123.30
40						\$1,227.60	\$2,028.40	\$1,986.00	\$2,325.30
42								\$2,043.40	\$2,391.40
44								\$2,140.50	\$2,505.10
46								\$2,235.60	\$2,616.80
48								\$2,333.50	\$2,731.30
50								\$2,429.40	\$2,843.80



In Cut

Ø in	Ends	30° Standard			45° Optional				
		Std Galv	Std 304SS	14ga Galv	Ends	Std Galv	Std 304SS	14ga Galv	12ga Galv
3		\$57.90	\$113.90						
4		\$57.90	\$113.90						
5		\$59.30	\$116.90						
6		\$63.70	\$123.80						
7		\$67.40	\$131.90						
8		\$70.60	\$138.30	\$106.00			\$116.40		
9		\$73.70	\$145.90	\$110.50			\$122.00		
10		\$79.70	\$155.70	\$119.70			\$132.40	\$156.20	
11		\$85.80	\$166.50	\$128.80			\$142.80	\$168.50	
12		\$85.80	\$166.50	\$128.80			\$147.80	\$173.50	
13		\$97.10	\$190.50	\$145.60			\$165.90	\$195.10	
14		\$97.10	\$190.50	\$145.60			\$167.50	\$196.60	
15		\$109.50	\$213.70	\$164.20			\$186.50	\$219.30	
16		\$109.50	\$213.70	\$164.20			\$200.30	\$233.10	
17		\$121.50	\$238.50	\$182.30			\$220.40	\$256.80	
18	QF	\$121.50	\$238.50	\$182.30	AFL		\$221.90	\$258.20	
20		\$193.20	\$285.10	\$289.90			\$333.90	\$391.80	
22		\$265.80	\$621.40	\$398.70			\$445.50	\$525.20	
24		\$305.90	\$714.60	\$458.70			\$506.80	\$598.50	
26						\$385.40	\$1,039.40	\$547.20	\$661.00
28						\$421.30	\$1,131.30	\$598.70	\$723.00
30						\$466.10	\$1,223.70	\$663.70	\$801.40
32						\$511.10	\$1,248.50	\$729.60	\$880.70
34						\$619.20	\$1,291.50	\$889.30	\$1,072.60
36						\$682.70	\$1,322.60	\$982.10	\$1,184.40
38						\$720.70	\$1,461.10	\$1,034.80	\$1,248.20
40						\$758.30	\$1,554.90	\$1,089.30	\$1,313.90
42								\$1,122.40	\$1,326.80
44								\$1,175.90	\$1,389.90
46								\$1,228.70	\$1,452.50
48								\$1,282.30	\$1,515.90
50								\$1,335.30	\$1,578.50



Tap In

Ø in	Ends	30° Standard			45° Optional				
		Std Galv	Std 304SS	14ga Galv	Ends	Std Galv	Std 304SS	14ga Galv	12ga Galv
3		\$57.90	\$113.90						
4		\$57.90	\$113.90						
5		\$59.30	\$116.90						
6		\$63.70	\$123.80						
7		\$67.40	\$131.90						
8		\$70.60	\$138.30	\$106.00				\$116.40	
9		\$73.70	\$145.90	\$110.50				\$122.00	
10		\$79.70	\$155.70	\$119.70				\$132.40	\$156.20
11		\$85.80	\$166.50	\$128.80				\$142.80	\$168.50
12		\$85.80	\$166.50	\$128.80				\$147.80	\$173.50
13		\$97.10	\$190.50	\$145.60				\$165.90	\$195.10
14		\$97.10	\$190.50	\$145.60				\$167.50	\$196.60
15		\$109.50	\$213.70	\$164.20				\$186.50	\$219.30
16		\$109.50	\$213.70	\$164.20				\$200.30	\$233.10
17		\$121.50	\$238.50	\$182.30				\$220.40	\$256.80
18	QF	\$121.50	\$238.50	\$182.30	AFL			\$221.90	\$258.20
20		\$193.20	\$285.10	\$289.90				\$333.90	\$391.80
22		\$265.80	\$621.40	\$398.70				\$445.50	\$525.20
24		\$305.90	\$714.60	\$458.70				\$506.80	\$598.50
26						\$371.10	\$1,039.40	\$547.20	\$661.00
28						\$421.30	\$1,131.30	\$598.70	\$723.00
30						\$466.10	\$1,223.70	\$663.70	\$801.40
32						\$511.10	\$1,248.50	\$729.60	\$880.70
34						\$620.40	\$1,291.50	\$889.30	\$1,072.60
36						\$682.70	\$1,322.60	\$982.10	\$1,184.40
38						\$720.70	\$1,461.10	\$1,034.80	\$1,248.20
40						\$758.30	\$1,554.90	\$1,089.30	\$1,313.90
42								\$1,122.40	\$1,326.80
44								\$1,175.90	\$1,389.90
46								\$1,228.70	\$1,452.50
48								\$1,282.30	\$1,515.90
50								\$1,335.30	\$1,578.50



Reducer

Ø in	Ends	Std Galv	Std 304SS	14ga Galv	Ends	Std Galv	Std 304SS	14ga Galv	12ga Galv
3		\$54.10	\$101.40						
4		\$54.10	\$101.40						
5		\$55.10	\$102.00						
6		\$58.00	\$111.10						
7		\$58.40	\$112.60						
8		\$59.50	\$113.50	\$89.20				\$109.20	
9		\$67.40	\$130.00	\$101.10				\$123.10	
10		\$68.50	\$131.10	\$102.60				\$127.10	\$147.60
11		\$80.70	\$157.10	\$121.10				\$147.70	\$172.00
12		\$80.70	\$157.10	\$121.10				\$154.00	\$178.20
13		\$96.20	\$183.30	\$144.30				\$183.60	\$212.60
14		\$96.20	\$183.30	\$144.30				\$186.60	\$215.50
15		\$132.70	\$252.60	\$199.10				\$243.40	\$283.20
16		\$132.70	\$252.60	\$199.10				\$257.60	\$297.40
17		\$138.40	\$263.80	\$207.80				\$281.90	\$323.40
18	QF	\$138.40	\$263.80	\$207.80	AFL			\$285.20	\$326.70
20		\$147.10	\$283.00	\$220.80				\$306.30	\$350.50
22		\$167.60	\$320.00	\$251.40				\$344.50	\$394.80
24		\$184.70	\$368.80	\$276.90				\$372.70	\$428.00
26						\$202.20	\$477.60	\$391.00	\$433.10
28						\$223.20	\$506.00	\$441.60	\$488.70
30						\$243.10	\$548.80	\$481.50	\$533.20
32						\$268.50	\$598.60	\$533.60	\$591.90
34						\$294.50	\$662.70	\$584.20	\$648.80
36						\$324.70	\$732.40	\$645.00	\$717.30
38						\$357.90	\$805.10	\$707.40	\$787.20
40						\$393.50	\$887.90	\$783.30	\$872.30
42								\$843.20	\$939.90
44								\$883.20	\$984.60
46								\$922.70	\$1,028.80
48								\$962.60	\$1,073.30
50								\$1,002.70	\$1,118.00

NOTE: See page 26 for returnable sizes

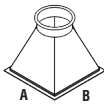

Transition Rect to Round

SQ to SQ Size	SQ End	Std Galv	Std 304SS	SQ End	Std Galv	Std 304SS	Standard Metal Thickness	* A x B=SQ
16		\$116.50	\$236.50		\$128.20	\$298.90	22ga	
36		\$128.50	\$273.70		\$144.10	\$333.40	22ga	
64		\$139.00	\$292.70		\$160.50	\$354.30	22ga	
100		\$146.60	\$316.20		\$180.10	\$382.60	22ga	
144		\$151.90	\$328.80		\$193.50	\$398.90	22ga	
196		\$159.40	\$338.30		\$216.10	\$422.60	20ga	
256		\$169.80	\$366.00		\$232.70	\$486.30	20ga	
324		\$203.10	\$435.00		\$273.20	\$567.70	20ga	
400		\$233.90	\$500.20		\$309.10	\$655.70	18ga	
484		\$365.60	\$840.90		\$470.30	\$1,049.20	18ga	
576		\$486.50	\$1,119.10		\$601.80	\$1,330.70	18ga	
676		\$615.70	\$1,416.30		\$741.90	\$1,631.30	16ga	
784		\$801.70	\$1,844.10		\$934.20	\$2,063.60	16ga	
900		\$1,000.90	\$2,301.90		\$1,397.50	\$2,524.20	16ga	
1024		\$1,250.80	\$2,701.04		\$1,667.80	\$2,986.30	16ga	
1156		\$1,291.06	\$2,787.06		\$1,750.00	\$3,414.10	16ga	
1296		\$1,766.20	\$2,907.49		\$1,765.90	\$3,879.40	16ga	
1444	SQ End RAW	\$1,796.58	\$3,045.13	SQ End FLANGE	\$1,791.06	\$4,311.50	14ga	
1600		\$1,839.11	\$3,251.58		\$1,807.83	\$4,779.80	14ga	
1764		\$1,887.71	\$3,544.05		\$1,832.99	\$5,253.90	14ga	
1936		\$1,960.61	\$4,470.20		\$1,862.35	\$5,726.70	14ga	
2116		\$2,063.89	\$4,665.43		\$1,895.90	\$6,196.10	14ga	
2304		\$2,532.70	\$4,866.85		\$2,371.04	\$6,670.90	14ga	
2500		\$2,600.91	CALL		\$2,401.42	CALL	12ga	
2704		\$2,671.29	CALL		\$2,443.94	CALL	12ga	
2916		\$2,743.83	CALL		\$2,492.55	CALL	12ga	
3136		\$2,818.54	CALL		\$2,565.45	CALL	12ga	
3364		\$2,895.41	CALL		\$2,668.73	CALL	12ga	
3600		\$3,210.76	CALL		\$3,339.15	CALL	12ga	
3844		\$3,291.97	CALL		\$3,407.36	CALL	10ga	
4096		\$3,375.34	CALL		\$3,477.74	CALL	10ga	
4356		\$3,460.87	CALL		\$3,550.28	CALL	10ga	
4624		\$3,548.57	CALL		\$3,624.99	CALL	10ga	
4900		\$3,638.44	CALL		\$3,701.86	CALL	10ga	
5184		\$3,966.78	CALL		\$4,017.21	CALL	10ga	

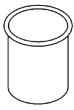

Machine Adapter

Ø in	Ends	Std Galv	Std 304SS	14ga Galv
3		\$23.80 #	\$43.80	
4		\$23.80 #	\$43.80	
5		\$26.40 #	\$50.50	
6		\$31.00 #	\$60.40	
7		\$33.20 #	\$65.00	
8		\$35.80 #	\$70.00	\$53.70
9		\$37.90 #	\$74.50	\$56.70
10		\$40.40 #	\$79.10	\$60.50
11		\$43.00 #	\$83.70	\$64.20
12		\$43.00 #	\$83.70	\$64.20
13		\$45.50 #	\$88.30	\$68.20
14	QF	\$45.50 #	\$88.30	\$68.20
15		\$47.60 #	\$94.40	\$71.40
16		\$47.60 #	\$94.40	\$71.40
17		\$52.50 #	\$102.20	\$78.80
18		\$52.50 #	\$102.20	\$78.80
19		\$54.30 #	\$106.80	\$81.40
20		\$54.30 #	\$106.80	\$81.40
21		\$59.60 #	\$112.80	\$89.40
22		\$59.60 #	\$112.80	\$89.40
23		\$68.70 #	\$129.70	\$103.10
24		\$68.70 #	\$129.70	\$103.10



Hose Adapter

Ø in	Ends	Std Galv	Std 304SS	14ga Galv
3		\$24.10 #	\$44.70	
4		\$24.10 #	\$44.70	
5		\$26.90 #	\$51.30	
6		\$31.60 #	\$61.40	
7		\$34.10 #	\$66.10	
8		\$36.50 #	\$71.00	\$54.70
9		\$38.60 #	\$75.70	\$57.80
10		\$41.00 #	\$80.50	\$61.60
11		\$43.90 #	\$85.20	\$66.00
12		\$43.90 #	\$85.20	\$66.00
13		\$46.30 #	\$89.80	\$69.50
14	QF	\$46.30 #	\$89.80	\$69.50
15		\$48.50 #	\$96.10	\$72.70
16		\$48.50 #	\$96.10	\$72.70
17		\$53.50 #	\$103.80	\$80.20
18		\$53.50 #	\$103.80	\$80.20
19		\$55.20 #	\$108.60	\$82.90
20		\$55.20 #	\$108.60	\$82.90
21		\$60.80 #	\$115.00	\$91.20
22		\$60.80 #	\$115.00	\$91.20
23		\$69.80 #	\$132.00	\$104.70
24		\$69.80 #	\$132.00	\$104.70



End Cap

Ø in	Ends	Std Galv	Std 304SS	14ga Galv
3		\$16.50	\$32.40	
4		\$16.50	\$32.40	
5		\$17.80	\$35.90	
6		\$20.10	\$39.70	
7		\$22.60	\$45.00	
8		\$23.90	\$48.50	\$35.80
9		\$26.10	\$52.30	\$39.30
10		\$27.30	\$56.00	\$41.00
11		\$28.80	\$59.70	\$43.30
12		\$28.80	\$59.70	\$43.30
13		\$30.70	\$63.00	\$46.10
14	QF	\$30.70	\$63.00	\$46.10
15		\$32.30	\$66.50	\$48.50
16		\$32.30	\$66.50	\$48.50
17		\$34.30	\$70.10	\$51.40
18		\$34.30	\$70.10	\$51.40
19		\$36.50	\$75.60	\$54.70
20		\$36.50	\$75.60	\$54.70
21		\$37.60	\$93.00	\$56.60
22		\$37.60	\$93.00	\$56.60
23		\$43.50	\$106.80	\$65.20
24		\$43.50	\$106.80	\$65.20



End Cap with Birdscreen

Ø in	Ends	Std Galv	Std 304SS
3		\$41.70	\$47.20
4		\$41.70	\$47.20
5		\$43.50	\$50.70
6		\$45.10	\$54.40
7		\$48.20	\$59.80
8		\$49.40	\$63.40
9		\$51.60	\$67.20
10		\$52.70	\$70.90
11		\$54.40	\$74.50
12		\$54.40	\$74.50
13		\$56.10	\$78.10
14	QF	\$56.10	\$78.10
15		\$57.50	\$81.60
16		\$57.50	\$81.60
17		\$59.90	\$85.20
18		\$59.90	\$85.20
19		\$61.80	\$90.60
20		\$61.80	\$90.60
21		\$63.10	\$108.20
22		\$63.10	\$108.20
23		\$72.40	\$124.30
24		\$72.40	\$124.30



End Plate

Ø in	14ga Galv	12ga Galv
8	\$17.30	\$18.60
9	\$19.10	\$20.70
10	\$22.80	\$24.60
11	\$29.80	\$32.10
12	\$29.80	\$32.10
13	\$37.00	\$39.90
14	\$37.00	\$39.90
15	\$50.50	\$54.40
16	\$50.50	\$54.40
17	\$53.40	\$57.50
18	\$53.40	\$57.50
20	\$56.10	\$60.40
22	\$62.30	\$67.20
24	\$66.90	\$72.20
26	\$93.10	\$100.50
28	\$102.60	\$110.70
30	\$112.30	\$121.20
32	\$117.90	\$127.30
34	\$127.50	\$137.50
36	\$131.30	\$141.60
38	\$133.20	\$143.70
40	\$142.70	\$154.00
42	\$146.80	\$158.40
44	\$154.50	\$166.50
46	\$161.40	\$174.30
48	\$168.70	\$182.00

#-Denotes an item that is returnable. See page 26 for a full listing of returnable items.



Blast Gate Manual

Ø in	Ends	Std Galv	Std 304SS ◇	14ga Galv	Ends	Std Galv	Std 304SS ◇	14ga Galv	12ga Galv
3		\$39.40 #	\$173.90						
4		\$39.40 #	\$173.90						
5		\$41.00 #	\$204.00						
6		\$53.90 #	\$277.00						
7		\$63.80 #	\$290.30						
8		\$75.50 #	\$294.70	\$375.30				\$381.30	
9		\$104.50 #	\$379.50	\$435.40				\$441.20	
10		\$132.80 #	\$409.70	\$495.40				\$501.20	\$520.90
11 ◇		\$172.40	\$517.90	\$645.60				\$657.60	\$683.40
12		\$172.40 #	\$517.90	\$645.60				\$657.60	\$683.40
14		\$255.30 #	\$598.30	\$795.70				\$807.90	\$839.70
16 ◇		\$371.50	\$1,112.00	\$885.80				\$922.70	\$958.10
18 ◇	QF	\$472.00	\$1,266.00	\$1,021.00	AFL			\$1,059.10	\$1,099.90
20 ◇		\$584.80	\$1,779.00	\$1,111.00				\$1,154.50	\$1,199.00
22 ◇		\$638.40	\$1,826.00	\$1,261.20				\$1,304.40	\$1,354.80
24 ◇		\$754.40	\$1,878.00	\$1,411.30				\$1,450.90	\$1,507.40
26 ◇						\$1,440.00	CALL	\$1,636.60	\$1,699.70
28 ◇						\$1,666.80	CALL	\$1,790.10	\$1,859.30
30 ◇						\$2,045.70	CALL	\$1,914.80	\$1,988.70
32								\$2,037.10	\$2,115.90
34								\$2,133.20	\$2,215.50
36								\$2,199.90	\$2,284.70
38								\$2,534.30	\$2,632.20
40								\$3,032.40	\$3,150.50

◇ SS Blast Gates have a production time of 7 days minimum.



Blast Gate NFMES

Ø in	Ends	Std Galv	Std 304SS ◇
3		\$371.10	\$636.40
4		\$371.10	\$636.40
5		\$392.10	\$672.80
6		\$403.00	\$691.00
7		\$432.60	\$741.80
8	QF	\$447.30	\$767.20
9		\$475.00	\$814.60
10		\$530.20	\$909.10
12		\$549.20	\$941.80
14		\$564.20	\$967.30
16 ◇		\$600.10	\$1,014.90

◇ SS Blast Gates have a production time of 7 days minimum.

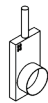

SD Automatic Blast Gate

Ø in	Ends	Std Galv
3		\$618.60
4		\$618.60
5		\$630.90
6		\$630.90
7		\$680.40
8		\$742.20
9		\$773.30
10	QF	\$773.30
12		\$804.20
14		\$897.00
16 ◇		\$1,002.00
18 ◇		\$1,113.40
20 ◇		\$1,200.00
22 ◇		\$1,311.30
24 ◇		\$1,459.80

◇ Items may take longer than standard lead times.

120V Control Circuit and 75psi minimum air pressure is standard. Optional 24V DC or AC control circuits available.

Reed Switch Assembly 1.06

Price Per Assembly
\$101.40



Blast Gate NFES Automatic

Ø in	Ends	Std Galv	Std 304SS ◇	14ga Galv	Ends	14ga Galv	12ga Galv
3		\$989.60	\$2,109.10				
4		\$989.60 #	\$2,109.10				
5		\$1,039.20 #	\$2,120.20				
6		\$1,039.20 #	\$2,130.90				
7		\$1,064.00 #	\$2,141.80				
8		\$1,064.00 #	\$2,341.80	\$1,127.90		\$1,148.70	
9		\$1,113.40	\$2,942.00	\$1,180.20		\$1,203.50	
10	QF	\$1,144.30	\$2,996.60	\$1,213.10	AFL	\$1,238.50	\$1,284.30
12		\$1,175.30	\$3,171.00	\$1,245.80		\$1,283.70	\$1,330.60
14		\$1,311.30	\$3,360.00	\$1,390.00		\$1,433.90	\$1,486.30
16 ◇		\$1,484.60	\$3,476.70	\$1,573.70		\$1,645.90	\$1,705.30
18 ◇		\$1,595.90	\$3,899.50	\$1,691.60		\$1,770.60	\$1,834.40
20 ◇		\$1,732.00	\$4,200.10	\$1,835.90		\$1,923.80	\$1,993.10
22 ◇		\$1,793.80	\$4,545.60	\$1,901.50		\$1,995.20	\$2,066.90

◇ SS Blast Gates have a production time of 7 days minimum.

120V Control Circuit and 75psi minimum air pressure is standard. Optional 24V DC or AC control circuits available.

#-Denotes an item that is returnable. See page 26 for a full listing of returnable items.



Ø in	Price PER FOOT
1	\$4.60
1.5	\$4.60
2	\$5.00
2.5	\$6.40
80 mm	\$7.50
3.5	\$7.80
4	\$7.80
5	\$9.90
6	\$12.60
7	\$14.70
8	\$16.20
9	\$24.30
10	\$25.10
12	\$25.90
14	\$38.80
16	\$44.70
18	\$50.70
20	\$54.10
24	\$71.90



Ø in	Price PER FOOT
2	\$5.90
2.5	\$7.30
80 mm	\$8.70
4	\$10.00
5	\$11.60
5.5	\$12.10
6	\$15.00
7	\$16.70
8	\$19.30
9	\$26.50
10	\$28.90
12	\$29.30
14	\$43.30
16	\$50.00



Ø in	Price PER FOOT
80 mm	\$15.20
4	\$17.90
5	\$24.00
6	\$26.50
8	\$29.60
10	\$37.60
12	\$52.80



Ø in	304SS
2	\$3.00 #
3	\$3.00 #
4	\$4.90 #
5	\$4.90 #
6	\$6.10 #
7	\$7.30 #
8	\$9.10 #
9	\$9.90 #
10	\$10.30 #
12	\$14.90 #
14	\$15.90
16	\$18.00
18	\$19.10
20	\$20.50
22	\$22.40
24	\$24.30



Ø in	Galv Price PER FOOT	304SS Price PER FOOT
1.5	\$6.00	N/A
2	\$7.60	\$20.70
2.5	\$7.90	N/A
3	\$11.60	\$30.50
4	\$14.50	\$40.30
5	\$17.80	\$50.10
6	\$21.90	\$51.40
7	\$25.00	\$58.20
8	\$28.50	\$66.00
9	\$31.90	\$77.10
10	\$34.40	\$78.80
12	\$41.70	\$91.70
14	\$48.20	\$108.00



Ø in	Galv Price PER FOOT	304SS Price PER FOOT
3	\$21.70	\$51.30
4	\$21.70	\$51.30
5	\$27.00	\$63.50
6	\$33.00	\$77.70
7	\$39.00	\$91.60
8	\$44.10	\$101.60



Ø in	304SS
2	\$6.70
2.5	\$7.30
3	\$7.20
4	\$7.90
5	\$8.70
6	\$10.70
7	\$12.30
8	\$13.20
10	\$15.60
12	\$22.50

◊ Items may take longer than standard lead times.

◊ Items may take longer than standard lead times.

Flex Hose Styles

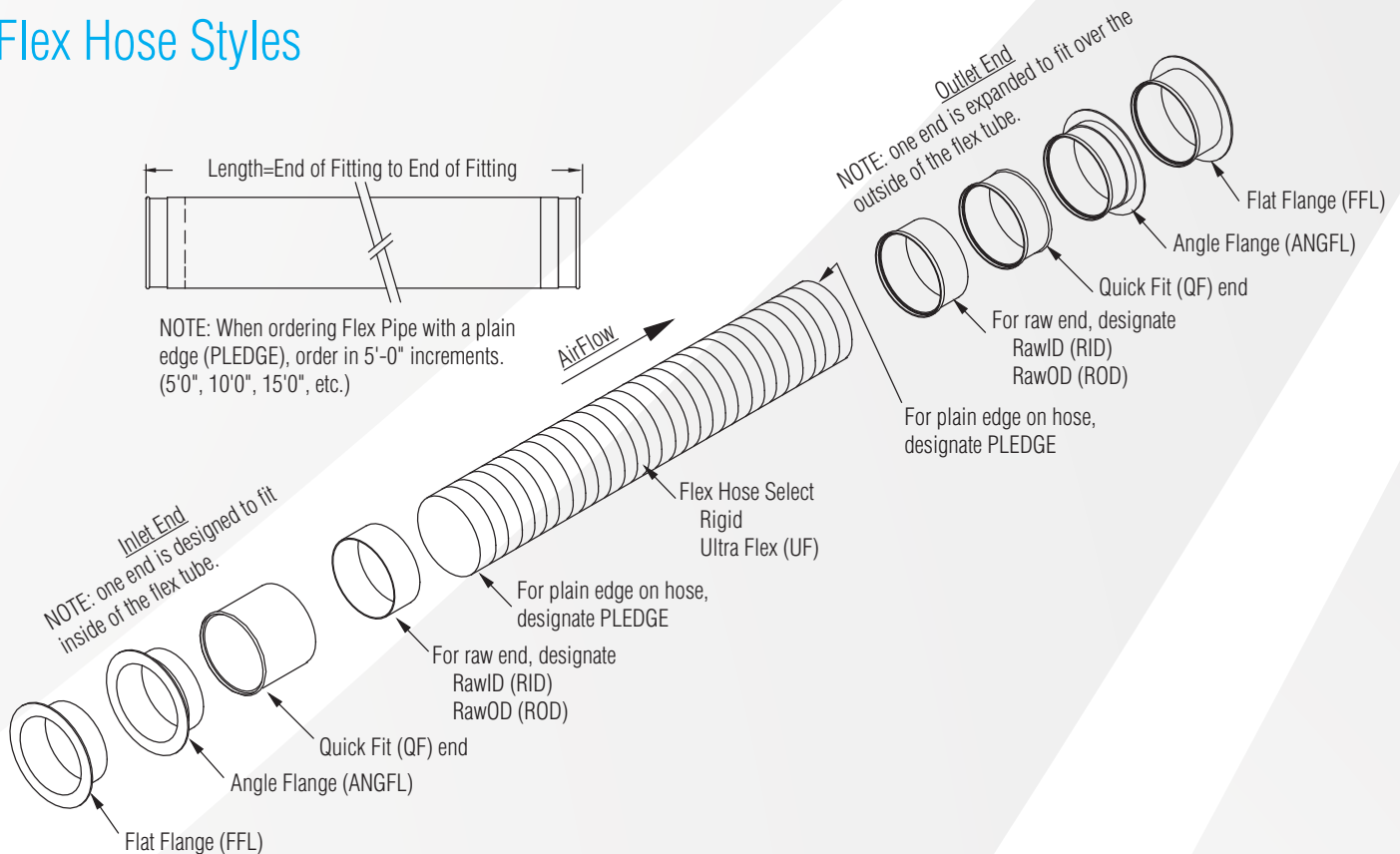

#-Denotes an item that is returnable. See page 26 for a full listing of returnable items.



Bell Mouth Hood

Ø in	Ø End	Galv	304SS ◇
3		\$87.60	\$150.50
4		\$87.60	\$150.50
5		\$101.70	\$174.40
6		\$111.30	\$191.30
7		\$119.00	\$204.20
8		\$127.70	\$219.20
9		\$139.50	\$239.70
10		\$150.20	\$258.10
11		\$179.60	\$308.20
12	QF	\$179.60	\$308.20
13		\$182.70	CALL
14		\$182.70	CALL
15		\$186.10	CALL
16		\$186.10	CALL
17		\$215.20	CALL
18		\$215.20	CALL
20		\$244.30	CALL
22		\$273.40	CALL
24		\$314.70	CALL

◇ SS Bell Mouth Hoods have a lead time of 4-5 business days minimum.

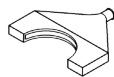

Barrel Hood

Ø in	Ends	Std Galv	Std 304SS ◇
4		\$403.40	\$1,118.20
6	QF	\$432.40	\$1,198.70
8		\$446.50	\$1,250.90

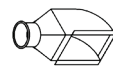

Radial Arm Saw Hood

Ø in	Ø End	Galv	304SS
4		\$217.80	
5	QF	\$265.60	Call Nordfab
6		\$365.00	



Canopy Hood

Ø in	Ø End	Rect. End	Std Galv	Std 304SS ◇	14ga Galv	Ends	14ga Galv	12ga Galv
16		18" square	\$203.10	\$441.30	\$304.60		\$342.60	
16	QF	24" square	\$371.20	\$805.00	\$556.80		\$594.90	\$706.30
18		36" square	\$960.00	\$2,074.70	\$1,440.10	AFL	\$1,479.60	\$1,767.50
18		48" square	\$1,707.20	\$3,689.70	\$2,560.90		\$2,600.40	\$3,112.50



Suction Hood

Ø End	No. of Pickups	Galv	304SS
	2	\$244.30	\$515.20
	3	\$277.80	\$591.20
QF	4	\$306.80	\$653.60
	5	\$376.80	\$798.00
	6	\$516.20	\$1,096.40



Router Hood

Ø in	Ø End	Galv	304SS
3		\$184.10	\$510.80
4		\$184.10	\$510.80
5		\$189.20	\$525.00
6	QF	\$195.30	\$542.30
7		\$201.30	\$558.90
8		\$206.90	\$574.20
9		\$215.20	\$597.30
10		\$229.60	\$637.00



Router Hood with Magnet

Ø in	Ø End	Galv	304SS
3		\$231.10	\$641.30
4		\$231.10	\$641.30
5		\$236.50	\$656.60
6	QF	\$243.90	\$677.30
7		\$248.60	\$689.50
8		\$252.70	\$701.60
9		\$261.60	\$726.00
10		\$276.60	\$768.20



Manual Diverter Valve

Ø in	Ends	Std Mild Steel	Std 304SS	14ga Galv Transition	Ends	14ga Galv Transition	12ga Galv Transition
3		\$1,500.90	\$2,162.10				
4		\$1,500.90	\$2,162.10				
5		\$1,691.00	\$2,363.00				
6		\$1,807.50	\$2,523.80				
7		\$1,904.40	\$2,660.40				
8		\$1,994.00	\$2,785.10	\$2,153.60		\$2,185.00	
9		\$2,083.60	\$2,909.60	\$2,250.40		\$2,285.10	
10		\$2,169.80	\$3,030.10	\$2,343.40		\$2,381.50	\$2,468.40
11		\$2,311.60	\$3,227.40	\$2,496.40		\$2,538.20	\$2,630.70
12	QF	\$2,311.60	\$3,227.40	\$2,496.40	AFL	\$2,553.20	\$2,645.70
13		\$2,526.60	\$3,528.50	\$2,728.70		\$2,789.90	\$2,891.00
14		\$2,526.60	\$3,528.50	\$2,728.70		\$2,794.60	\$2,895.60
15		\$2,741.80	\$3,830.20	\$2,961.30		\$3,028.20	\$3,137.80
16		\$2,741.80	\$3,830.20	\$2,961.30		\$3,069.70	\$3,179.40
17		\$2,958.90	\$4,131.40	\$3,195.50		\$3,309.60	\$3,428.10
18		\$2,958.90	\$4,131.40	\$3,195.50		\$3,314.10	\$3,432.50
20		\$3,087.90	\$4,312.30	\$3,335.00		\$3,466.80	\$3,590.30
22		\$3,217.00	\$4,493.10	\$3,474.40		\$3,614.90	\$3,743.70
24		\$3,699.60	\$5,167.20	\$3,995.50		\$4,139.70	\$4,287.70

◇ Diverter Valves have a lead time of 7 days minimum



Automatic Diverter Valve

Ø in	Ends	Std Mild Steel	Std 304SS	14ga Galv	Ends	14ga Galv	12ga Galv
3		\$2,372.40	\$3,415.90				
4		\$2,372.40	\$3,415.90				
5		\$2,589.50	\$3,617.00				
6		\$2,878.10	\$4,018.70				
7		\$2,949.80	\$4,119.50				
8		\$3,050.40	\$4,259.90	\$3,294.40		\$3,325.70	
9		\$3,165.20	\$4,420.60	\$3,418.30		\$3,453.00	
10		\$3,382.10	\$4,722.40	\$3,652.50		\$3,690.80	\$3,826.00
11		\$3,597.20	\$5,023.60	\$3,884.80		\$3,926.70	\$4,070.60
12	QF	\$3,597.20	\$5,023.60	\$3,884.80	AFL	\$3,941.70	\$4,085.60
13		\$3,812.30	\$5,325.10	\$4,117.40		\$4,178.30	\$4,330.90
14		\$3,812.30	\$5,325.10	\$4,117.40		\$4,183.10	\$4,335.70
15		\$4,592.50	\$6,414.00	\$4,959.90		\$5,026.90	\$5,210.60
16		\$4,592.50	\$6,414.00	\$4,959.90		\$5,068.40	\$5,252.10
17		\$4,987.00	\$6,964.70	\$5,385.90		\$5,499.90	\$5,699.40
18		\$4,987.00	\$6,964.70	\$5,385.90		\$5,504.30	\$5,703.80
20		\$5,349.20	\$7,471.00	\$5,777.20		\$5,909.00	\$6,123.00
22		\$6,109.40	\$8,532.10	\$6,598.20		\$6,738.80	\$6,983.20
24		\$7,026.00	\$9,811.90	\$7,588.20		\$7,732.30	\$8,013.30

◇ Diverter Valves have a lead time of 7 days minimum

120V Control Circuit and 75psi minimum air pressure is standard. Optional 24V DC or AC control circuits available.

Reed Switch Assembly 2.50

Price PER ASSEMBLY
\$107.80



SD Manual Diverter Valve

Ø in	Ends	Std 14ga Galv	Std 304SS
3		\$1,161.00	\$1,405.40
4		\$1,161.00	\$1,405.40
5		\$1,161.00	\$1,405.40
6		\$1,398.00	\$1,640.50
7		\$1,398.00	\$1,640.50
8	QF	\$1,542.40	\$1,810.40
9		\$1,542.40	\$1,810.40
10		\$1,678.30	\$1,969.70
11		\$1,678.30	\$1,969.70
12		\$1,788.10	\$2,097.70
13		\$1,788.10	\$2,097.70

◇ Diverter Valves have a lead time of 7 days minimum



SD Automatic Diverter Valve ◇

Ø in	Ends	Std 14ga Galv	Std 304SS
3		\$1,835.10	\$2,220.30
4		\$1,835.10	\$2,220.30
5		\$1,835.10	\$2,220.30
6		\$2,226.20	\$2,612.20
7		\$2,226.20	\$2,612.20
8	QF	\$2,359.20	\$2,768.90
9		\$2,359.20	\$2,768.90
10		\$2,615.80	\$3,069.50
11		\$2,615.80	\$3,069.50
12		\$2,782.40	\$3,265.40
13		\$2,782.40	\$3,265.40

◇ Diverter Valves have a lead time of 7 days minimum

120V Control Circuit and 75psi minimum air pressure is standard. Optional 24V DC or AC control circuits available.



Gripple Hanger

Size Weight	Price
Up to 22lbs	\$7.80 #
Up to 100lbs	\$11.00 #
Up to 200lbs	\$13.20 #
Up to 495lbs	\$25.30 #
Up to 715lbs	\$33.20 #



Pipe Hanger

Ø in	Galv	304SS
3	\$8.60 #	\$18.20
4	\$8.60 #	\$18.20
5	\$9.40 #	\$19.70
6	\$10.90 #	\$22.40
7	\$10.90 #	\$25.00
8	\$13.00 #	\$28.80
9	\$16.20 #	\$35.50
10	\$16.90 #	\$38.00
11	\$18.90	\$42.10
12	\$18.90 #	\$42.10
13	\$21.50	\$47.50
14	\$21.50 #	\$47.50
15	\$27.90	\$59.00
16	\$27.90	\$59.00
17	\$29.60	\$60.50
18	\$29.60	\$60.50
20	\$32.40	\$65.80
22	\$39.90	\$80.10
24	\$45.70	\$92.10
26	\$52.00	\$101.10
28	\$56.50	\$106.30
30	\$58.70	\$121.00
32	\$72.60	\$149.70
34	\$79.60	\$165.60
36	\$89.20	\$182.60
38	\$98.50	\$201.10
40	\$108.00	\$220.90

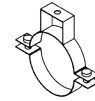

Pipe Hanger HJ

Ø in	Galv	304SS
3	\$17.00	\$36.90
4	\$17.00	\$36.90
5	\$19.10	\$40.90
6	\$21.60	\$46.80
7	\$21.60	\$46.80
8	\$25.80	\$55.80
9	\$31.90	\$68.80
10	\$34.00	\$72.90
11	\$37.60	\$81.00
12	\$37.60	\$81.00
13	\$43.00	\$92.70
14	\$43.00	\$92.70
15	\$55.80	\$119.60
16	\$55.80	\$119.60
17	\$58.90	\$127.10
18	\$58.90	\$127.10
20	\$64.90	\$139.20
22	\$79.60	\$171.30
24	\$91.70	\$197.00



Clamp Hanger

Ø in	Galv	304SS
3	\$24.00	\$51.40
4	\$24.00	\$51.40
5	\$26.60	\$57.40
6	\$30.30	\$65.40
7	\$30.30	\$65.40
8	\$36.20	\$78.10
9	\$44.70	\$96.50
10	\$47.60	\$102.00
11	\$52.80	\$113.60
12	\$52.80	\$113.60
13	\$64.30	\$129.50
14	\$64.30	\$129.50
15	\$78.00	\$167.50
16	\$78.00	\$167.50
17	\$82.70	\$177.60
18	\$82.70	\$177.60
20	\$90.70	\$195.60
22	\$111.50	\$239.80
24	\$128.50	\$276.20

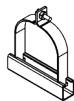

Strut Hanger

Size	Galv	304SS
3	\$12.90	\$27.50
4	\$12.90	\$27.50
5	\$14.30	\$29.80
6	\$16.40	\$33.50
7	\$16.40	\$37.20
8	\$19.40	\$43.40
9	\$24.10	\$53.20
10	\$25.50	\$57.10
11	\$28.20	\$63.10
12	\$28.20	\$63.10
13	\$32.30	\$71.10
14	\$32.30	\$71.10
15	\$41.80	\$88.80
16	\$41.80	\$88.80
17	\$44.50	\$90.70
18	\$44.50	\$90.70
20	\$48.60	\$98.60
22	\$60.10	\$120.20
24	\$68.70	\$138.10

#-Denotes an item that is returnable. See page 26 for a full listing of returnable items.



Wall Flashing

Ø in	Galv	304SS
4	\$50.30	\$89.00
5	\$52.90	\$99.00
6	\$63.30	\$110.80
7	\$68.40	\$119.00
8	\$71.20	\$125.10
9	\$79.70	\$128.10
10	\$84.00	\$133.30
12	\$93.10	\$139.60
14	\$97.10	\$151.00
16	\$105.60	\$173.10
18	\$114.50	\$203.20
20	\$121.70	\$216.50
22	\$130.30	\$232.80
24	\$149.80	\$267.70



Roof Flashing

Ø in	Galv	304SS
4	\$50.30	\$89.00
5	\$52.90	\$99.00
6	\$63.30	\$104.40
7	\$68.40	\$119.00
8	\$71.20	\$125.10
9	\$79.70	\$128.10
10	\$84.10	\$133.30
12	\$93.10	\$139.60
14	\$97.10	\$151.00
16	\$105.60	\$163.30
18	\$114.50	\$203.20
20	\$121.70	\$216.50
22	\$130.30	\$232.80
24	\$149.80	\$267.80



Roof Skirt

Ø in	Galv	304SS
4	\$59.50	\$113.50
5	\$67.40	\$130.00
6	\$68.50	\$131.10
7	\$80.70	\$157.10
8	\$80.70	\$157.10
9	\$96.20	\$183.30
10	\$96.20	\$183.30
12	\$132.70	\$252.60
14	\$138.40	\$263.80
16	\$147.10	\$283.00
18	\$167.60	\$320.60
20	\$184.70	\$368.80
22	\$202.20	\$456.10
24	\$223.20	\$506.00



No-Loss Stackhead

Ø in	Ends	Std Galv	Std 304SS	14ga Galv	Ends	Std Galv	Std 304SS	14ga Galv	12ga Galv
3		\$93.60	\$211.50						
4		\$93.60	\$211.50						
5		\$97.40	\$219.00						
6		\$103.70	\$234.60						
7		\$118.70	\$267.50						
8		\$144.60	\$325.90	\$216.90				\$227.40	
9		\$160.50	\$339.40	\$240.70				\$252.30	
10		\$177.80	\$401.20	\$266.80				\$279.60	\$333.00
11		\$209.00	\$471.40	\$313.50				\$327.50	\$390.20
12		\$209.00	\$471.40	\$313.50				\$332.40	\$395.20
13		\$248.40	\$560.50	\$372.60				\$392.90	\$467.40
14		\$248.40	\$560.50	\$372.60				\$394.60	\$469.00
15		\$291.40	\$657.60	\$437.00				\$459.40	\$546.80
16	QF	\$291.40	\$657.60	\$437.00	AFL			\$473.20	\$560.60
17		\$395.30	\$892.10	\$592.80				\$630.90	\$749.40
18		\$395.30	\$892.10	\$592.80				\$632.40	\$751.00
20		\$497.00	\$1,120.90	\$745.60				\$789.40	\$938.60
22		\$553.40	\$1,248.80	\$830.00				\$876.90	\$1,042.80
24		\$636.40	\$1,436.00	\$954.60				\$1,002.50	\$1,193.40
26						\$764.10	\$1,488.50	\$1,115.30	\$1,326.00
28						\$861.20	\$1,501.50	\$1,258.50	\$1,496.80
30						\$935.40	\$1,595.90	\$1,367.50	\$1,627.00
32						\$1,056.20	\$1,684.60	\$1,547.10	\$1,841.70
34						\$1,080.90	\$1,889.10	\$1,581.70	\$1,882.10
36						\$1,104.10	\$1,983.60	\$1,614.40	\$1,920.50
38						\$1,268.30	\$2,172.50	\$1,856.10	\$2,208.80
40						\$1,358.40	\$2,328.20	\$1,989.50	\$2,368.00



In-line Spark Trap

Ø in	Ends	Galv	Std 304SS	Ends	Galv	304SS
4		\$403.00	\$1,389.20		\$423.60	\$1,484.30
5		\$473.20	\$1,540.90		\$495.70	\$1,641.90
6		\$579.50	\$1,770.60		\$607.90	\$1,876.60
7		\$680.40	\$1,988.50		\$710.70	\$2,102.20
8		\$772.30	\$2,187.10		\$809.70	\$2,304.30
9		\$817.30	\$2,284.50		\$859.10	\$2,401.90
10		\$873.20	\$2,405.00		\$922.90	\$2,525.60
12	QF	\$932.70	\$2,533.30	AFL	\$997.80	\$2,660.00
14		\$1,139.00	\$2,979.00		\$1,219.60	\$3,112.30
16		\$1,268.40	\$3,382.30		\$1,340.60	\$3,494.60
18		\$1,426.90	\$3,805.00		\$1,506.00	\$3,932.70
20		\$1,585.40	\$4,227.80		\$1,673.40	\$4,370.70
22		\$1,744.00	\$4,650.60		\$1,837.70	\$4,805.40
24		\$1,902.50	\$5,073.40		\$1,998.60	\$5,243.70



Ball Joint

Ø in	Galv
4	\$199.20
6	\$251.70
8	\$335.30
10	\$440.30
12	\$492.70
14 *	\$859.40

* 14" diameter - up to 6 weeks lead time



Jet Cap

Ø in	Ends	Std Galv	Std 304SS	14ga Galv	Ends	Std Galv	Std 304SS	14ga Galv	12ga Galv
6		\$166.10	\$375.30						
8		\$231.40	\$521.60	\$347.20				\$357.60	
10		\$284.70	\$642.10	\$426.90				\$439.80	\$525.10
12		\$334.40	\$754.30	\$501.60				\$520.50	\$620.80
13		\$397.40	\$897.00	\$596.20				\$616.60	\$735.70
14		\$397.40	\$897.00	\$596.20				\$618.10	\$737.40
15		\$466.10	\$1,052.20	\$699.20				\$721.50	\$861.50
16		\$466.10	\$1,052.20	\$699.20				\$735.30	\$875.30
17		\$632.30	\$1,427.30	\$948.50				\$986.60	\$1,176.20
18		\$632.30	\$1,427.30	\$948.50				\$988.00	\$1,177.80
20	QF	\$795.30	\$1,793.50	\$1,192.80	AFL			\$1,236.80	\$1,475.50
22		\$885.50	\$1,994.20	\$1,328.30				\$1,375.00	\$1,640.60
24		\$1,018.30	\$2,297.70	\$1,527.40				\$1,575.40	\$1,881.00
26						\$1,222.50	\$2,381.60	\$1,802.80	\$2,151.20
28						\$1,377.70	\$2,402.40	\$2,033.30	\$2,426.80
30						\$1,496.60	\$2,553.40	\$2,209.60	\$2,637.20
32						\$1,690.10	\$2,695.20	\$2,497.90	\$2,982.40
34						\$1,729.50	\$3,022.50	\$2,554.50	\$3,049.60
36						\$1,766.60	\$3,173.80	\$2,607.90	\$3,112.80
38						\$2,029.20	\$3,476.00	\$2,997.40	\$3,578.40
40						\$2,173.70	\$3,725.00	\$3,212.30	\$3,835.40



Silencer

Ø in	Ends	Std Galv	Std 304SS	Ends	Std Galv	Std 304SS
3		\$563.50	\$1,062.30			
4		\$587.60	\$1,107.70			
5		\$606.40	\$1,142.70			
6		\$630.00	\$1,187.20			
7		\$736.80	\$1,388.60			
8		\$871.70	\$1,642.80			
9		\$939.30	\$1,770.10			
10		\$1,029.20	\$1,939.70			
12		\$1,068.50	\$2,013.80			
14		\$1,135.90	\$2,140.90			
16		\$1,287.90	\$2,427.10			
18	QF	\$1,395.70	\$2,895.20	AFL		
20		\$1,636.50	\$3,084.20			
22		\$1,771.50	\$3,338.80			
24		\$1,925.40	\$3,628.80			
26					\$2,889.00	\$5,444.60
28					\$2,911.20	\$5,486.50
30					\$2,970.40	\$5,598.10
32					\$3,058.50	\$5,764.00
34					\$3,089.20	\$5,822.10
36					\$3,681.30	\$6,937.70
38					\$3,762.10	\$7,090.50
40					\$3,789.00	\$7,140.70

Suction Nozzle Assembly

Ø in	Ends	Galve	304SS
4	QF	\$105.80	\$302.00



Butterfly Valve

Ø in	Ends	Galv	304SS
3		\$64.60	\$145.50
4		\$64.60	\$145.50
5		\$65.00	\$146.30
6		\$65.60	\$148.00
7		\$69.50	\$156.30
8		\$70.00	\$158.00
9		\$71.00	\$160.60
10		\$71.80	\$162.00
11		\$75.60	\$170.70
12	QF	\$75.60	\$170.70
13		\$86.50	\$194.80
14		\$86.50	\$194.80
15		\$92.70	\$208.90
16		\$92.70	\$208.90
17		\$100.50	\$226.80
18		\$100.50	\$226.80
20		\$112.80	\$254.90
22		\$125.20	\$283.00
24		\$144.10	\$325.50



Bleed-in Valve

Ø in	Ends	Galv	304SS
3		\$65.40	\$112.00
4		\$65.40	\$112.00
5		\$75.10	\$128.90
6		\$78.20	\$134.20
7		\$84.20	\$144.40
8		\$87.00	\$149.20
9		\$95.80	\$164.10
10		\$101.80	\$174.50
11		\$106.40	\$182.90
12	QF	\$106.40	\$182.90
13		\$117.20	\$201.40
14		\$117.20	\$201.40
15		\$128.50	\$220.30
16		\$128.50	\$220.30
17		\$143.50	\$246.20
18		\$143.50	\$246.20
20		\$166.00	\$285.20
22		\$184.70	\$317.10
24		\$212.20	\$364.80



Sliding Access Panel

Ø in	Ends	Galv	304SS
6		\$138.80	\$238.20
7		\$153.50	\$272.30
8		\$161.00	\$283.80
9		\$168.20	\$305.10
10		\$175.30	\$322.60
11		\$195.00	\$366.00
12		\$201.50	\$366.00
13	QF	\$238.70	\$449.30
14		\$238.70	\$449.30
15		\$278.40	\$523.70
16		\$278.40	\$523.70
17		\$308.70	\$596.10
18		\$308.70	\$596.10
20		\$352.00	\$690.80
22		\$385.30	\$765.90
24		\$433.30	\$872.00

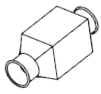

In Line Back Draft Damper

Ø in	Ends	Std Galv	Std 304SS	Ends	Std Galv	Std 304SS
3		\$182.70	\$312.90			
4		\$182.70	\$312.90			
5		\$230.70	\$395.30			
6		\$271.80	\$465.80			
7		\$317.40	\$543.90			
8		\$363.30	\$622.20			
9		\$401.80	\$688.80			
10		\$445.30	\$763.10			
11		\$488.40	\$837.40			
12		\$488.40	\$837.40			
13		\$538.80	\$923.60			
14		\$538.80	\$923.60			
15	QF	\$588.90	\$1,009.50	AFL		
16		\$588.90	\$1,009.50			
17		\$648.50	\$1,111.30			
18		\$648.50	\$1,111.30			
20		\$739.80	\$1,268.00			
22		\$915.40	\$1,569.20			
24		\$1,029.70	\$1,765.00			
26					\$1,105.00	\$1,893.90
28					\$1,150.60	\$1,972.20
30					\$1,280.70	\$2,195.40
32					\$1,365.30	\$2,340.20
34					\$1,456.50	\$2,496.70



Viewing Spool

Ø in	Ends	Galv	304SS
3		\$301.60	\$384.30
4		\$301.60	\$384.30
5		\$308.90	\$393.50
6		\$314.00	\$400.00
7		\$334.00	\$425.80
8		\$350.30	\$446.40
9	QF	\$384.60	\$490.30
10		\$409.90	\$522.40
11		\$449.50	\$572.90
12		\$449.50	\$572.90
14		\$491.00	\$625.70
16		\$516.20	\$657.80
18		\$646.00	\$716.00



Vibration Isolator

Ø in	Ends	Std Galv	Std 304SS	Ends	Std Galv	Std 304SS
3		\$86.80	\$148.60			
4		\$86.80	\$148.60			
5		\$94.30	\$161.40			
6		\$103.80	\$178.30			
7		\$116.10	\$199.30			
8		\$130.40	\$223.80			
9		\$136.90	\$234.90			
10		\$143.70	\$246.40			
11		\$216.80	\$371.70			
12		\$216.80	\$371.70			
13		\$248.40	\$425.80			
14		\$248.40	\$425.80			
15		\$302.80	\$519.40			
16	QF	\$302.80	\$519.40	AFL		
17		\$327.20	\$561.40			
18		\$327.20	\$561.40			
20		\$351.50	\$603.00			
22		\$382.60	\$656.00			
24		\$440.00	\$754.40			
26					\$450.90	\$1,507.20
28					\$484.30	\$1,587.20
30					\$512.80	\$1,658.20
32					\$544.00	\$1,737.40
34					\$576.70	\$1,815.20
36					\$611.20	\$1,901.10
38					\$648.30	\$2,093.50
40					\$687.30	\$2,257.00



Floor Sweep

Ø in	Ends	Galv	304SS
3		\$220.40	\$429.40
4		\$220.40	\$429.40
5		\$231.50	\$452.60
6		\$242.30	\$472.50
7	QF	\$264.10	\$533.60
8		\$277.20	\$558.60
9		\$288.20	\$582.20
10		\$299.10	\$599.10
11		\$310.00	\$658.90
12		\$310.00	\$658.90

◊ Items may take longer than standard lead times.

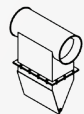

Drop Out Box

Ø in	Ends	Galv
6		\$1,450.00
7		\$1,480.00
8		\$1,525.00
9		\$1,630.00
10	QF	\$1,630.00
11		\$1,710.00
12		\$1,710.00
14		\$1,810.00
16		\$1,870.00



QFS Molded Gasket	Ø in	Gasket
	3	\$2.30
	4	\$2.30
	5	\$2.50
	6	\$2.70
	7	\$4.30
	8	\$4.50
	9	\$4.90
	10	\$5.30
	11	\$8.50
	12	\$8.50
	13	\$9.10
	14	\$9.10
15	\$10.60	
16	\$10.60	
18	\$11.70	
20	\$12.90	
22	\$16.10	
24	\$17.50	



QFS O-Ring	Ø in	O-Ring
	3	\$1.90
	4	\$1.90
	5	\$2.20
	6	\$2.20
	7	\$2.50
	8	\$2.60
	9	\$2.80
	10	\$2.90
	11	\$3.10
	12	\$3.10
	13	\$3.40
	14	\$3.40
15	\$3.70	
16	\$3.70	
18	\$4.00	
20	\$4.20	
22	\$4.50	
24	\$4.70	

QFS Caulking	Ø in	Caulking
	3	
	4	
	5	
	6	
	7	
	8	
	9	
	10	available on all non-laser welded parts
	11	
	12	
	13	25% Upcharge
	14	
15		
16		
18		
20		
22		
24		



Oil Mist Recycler	Ø in	Ends	Galv	304SS
	3		\$458.70	\$1,061.20
	4		\$458.70	\$1,061.20
	5		\$458.70	\$1,061.20
	6		\$458.70	\$1,061.20
	7	QF	\$546.60	\$1,264.40
	8		\$546.60	\$1,264.40
	9		\$546.60	\$1,264.40
	10		\$546.60	\$1,264.40
	12		\$659.20	\$1,525.10

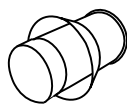

Oil Mist Drain Back For Hose	Ø in	Ends	Galv
	3		\$93.40
	4		\$98.40
	5		\$115.30
	6		\$122.30
	7	QF	\$124.20
	8		\$132.80
	9		\$141.60
	10		\$148.20
	12		\$158.20

Nordfab Americas: Terms & Conditions of Sale

Effective June 7, 2019

GENERAL TERMS

These Terms & Conditions of Sale (these "Terms") shall govern all conduct between the Buyer and Nordfab, LLC ("Nordfab") regardless of the nature or form of Buyer's offer to purchase products or services from Nordfab (the "Products"). To the extent a Nordfab order acknowledgement, invoice or other document or transmittal constitutes an acceptance of an offer from Buyer, such acceptance is expressly made conditional upon Buyer's assent to these Terms. "Buyer" means the individual or entity identified on Buyer's purchase order, or if different, on Nordfab's quote.

The entire agreement of Nordfab and Buyer is expressed exclusively in: (i) the terms, covenants and conditions set forth in these Terms, (ii) the drawings, specifications and descriptions attached hereto or transmitted herewith (if any) (collectively, the "Documentation"), (iii) a Nordfab quote and (iv) Nordfab's acceptance or acknowledgement of Buyer's purchase order. In the event that any quotation, proposal, purchase order, order acknowledgement, order acceptance and/or other sales form or documentation contains terms which are in addition to, different from or inconsistent with those set forth in these Terms, these Terms shall be controlling and any such additional, different or inconsistent terms and conditions shall be inapplicable and are hereby objected to. Receipt and acceptance by Buyer of Products supplied by Nordfab shall constitute Buyer's acceptance and assent to these Terms. Buyer should print and retain a copy of these Terms for its records.

These Terms shall be governed, construed, and enforced in accordance with the laws of the State of North Carolina, excluding that State's conflict of law principles, as to all matters arising out of or relating to these Terms. Nordfab and the Buyer exclude the application of the 1980 United Nations Convention on Contracts for the International Sale of Goods if otherwise applicable. Any claim, or litigation arising out of or relating to the Products shall be brought exclusively in a court of competent jurisdiction in Davidson County, North Carolina.

Nordfab and Buyer may modify these Terms, or the associated quote or purchase order acknowledgement, only by an express written agreement signed by both parties. Nordfab's waiver of any breach of any provision contained in these Terms will not waive any other breach by Buyer. Nordfab's delay or failure to enforce its rights under these Terms shall not be deemed a waiver of such rights. The relationship between the parties is that of independent contractors. Neither party shall have authority to contract for or bind the other party in any manner whatsoever. Any part of these Terms held to be invalid or unenforceable by a tribunal of competent jurisdiction shall be deemed ineffective to the extent thereof without affecting the validity or enforceability of any other part of these Terms. Provisions of these Terms which by their nature should apply beyond their terms will remain in force after any termination or expiration of these Terms.

These Terms are binding upon, and shall inure to the benefit of Buyer, Nordfab and their successors and permitted assigns. Buyer may not assign all or any portion of its rights or obligations hereunder without the prior written consent of Nordfab. Nordfab may assign, delegate or subcontract a purchase order or any of its obligations under these Terms, in whole or in part, without Buyer's consent.

LIMITED WARRANTY

Nordfab warrants that the Products sold hereunder conform to any applicable Documentation and will be free from any defects in material and workmanship which become apparent under normal use. This limited warranty applies to the original Buyer only and is non-transferable. To make a claim under this limited warranty, Buyer must give written notice to Nordfab within a period of 12 months from the date of installation or 12 months from the date of shipment, whichever period first expires. If, within that period, Nordfab receives from Buyer written notice of any alleged defect in or non-conformance of any Product covered by this limited warranty and if, in Nordfab's sole judgment, the Product does not conform with this limited warranty, then Buyer shall, at Nordfab's request, return the part or Product F.O.B. Nordfab's shipping point. Nordfab, at its sole option and expense, shall then repair or replace the defective part or Product or repay Buyer the full price paid for such part or Product. Dismounting of defective or non-conforming parts and remounting of any repaired or replaced parts is at Buyer's sole expense. This Limited Warranty, as it relates to the delivery of spare parts or replacement for non-conforming parts, expires when the limited warranty for the original Product or equipment expires. Any repayment of purchase price shall be without interest. NORFAB'S SOLE RESPONSIBILITY, AND BUYER'S EXCLUSIVE REMEDY HEREUNDER, SHALL BE LIMITED TO SUCH REPAIR, REPLACEMENT, OR REPAYMENT OF THE PURCHASE PRICE AS ABOVE PROVIDED. NO OTHER WARRANTIES, EXPRESS, STATUTORY, OR IMPLIED, ARE MADE AND ANY AND ALL IMPLIED WARRANTIES OF MERCHANTABILITY, QUALITY, OR FITNESS FOR PARTICULAR PURPOSE ARE EXPRESSLY DISCLAIMED. This limited warranty does not cover and Nordfab makes no warranty with respect to:

- A) failures not reported to Nordfab within the warranty period specified above;
- B) failure or damage due to misapplication, abuse, improper installation or abnormal conditions of any kind, including, but not limited to, temperature, dirt or other corrosive matter;
- C) failures due to operation, either intentional or otherwise, above rated capacities or in an otherwise improper manner;
- D) Products which have been in any way tampered with or altered by anyone other than an authorized representative of Nordfab;
- E) Products damaged in shipment or otherwise without fault of Nordfab;
- F) expenses incurred by Buyer in an attempt to repair, rework, or replace any alleged defective Product; and
- G) defects in material and workmanship which are attributable to drawings and specifications provided by Buyer.

TERMS OF PAYMENT

Unless agreed to in writing by an authorized officer of Nordfab, the payment terms hereunder are NET 30. If the full purchase price is not paid by Buyer NET 30, then interest shall accrue at the rate of 1.5% per month. Buyer agrees that if Nordfab is required to bring suit to collect any sums due Nordfab under these Terms, then Buyer shall be responsible for all costs and expenses incurred by Nordfab, including but not limited to Nordfab's reasonable attorney's fees.

ORDERING NOTES:

Unless specified, 3" through 24" is QF; over 24" is flanged. Data is subject to change without notice. Stainless steel components requiring flanges will be supplied with SS flanges unless otherwise specified. Stainless steel components are manufactured with No. 304 SS. [Call for SS 316 Prices] Adding "SS" after standard part numbers specifies a standard 304SS part. For special parts or items to be custom manufactured, call for quotation.

CLAIMS FOR SHORTAGES

Any claims for loss, breakage (obvious or concealed), or shortage are Buyer's sole responsibility and should be made to the carrier immediately. Nordfab will render Buyer reasonable assistance in securing satisfactory adjustment of such claims. Any notice of shortages or other errors must be made in writing to Nordfab within 30 days after receipt of shipment. Failure to give such notice shall constitute unqualified acceptance of the Product and a waiver by Buyer of all claims against Nordfab for loss, breakage or shortage. Risk of loss for damage to Products sold under these Terms passes to Buyer when the carrier takes custody of any of the Products purchased under these Terms regardless of which party pays shipping costs.

LIMITATION OF LIABILITY

IN NO EVENT SHALL NORFAB BE LIABLE FOR ANY SPECIAL, INDIRECT, INCIDENTAL, CONSEQUENTIAL OR COMPENSATORY DAMAGES OF ANY CHARACTER, INCLUDING, BUT NOT LIMITED TO, LOSS OF USE OF PRODUCTION FACILITIES OR EQUIPMENT, LOST REVENUES OR PROFITS, BUSINESS OR GOODWILL, PROPERTY DAMAGE, EXPENSES INCURRED IN RELIANCE ON NORFAB'S PERFORMANCE HEREUNDER, AND/OR LOST PRODUCTION, WHETHER SUFFERED BY BUYER OR ANY THIRD PARTY, IN EACH CASE EVEN IF NORFAB HAS BEEN ADVISED OR IS AWARE OF THE POSSIBILITY OF SUCH DAMAGES. UNDER NO CIRCUMSTANCES SHALL NORFAB'S AGGREGATE LIABILITY ARISING OUT OF OR IN CONNECTION WITH THE SALE OF PRODUCTS, IN CONTRACT, TORT OR OTHERWISE, EXCEED THE PURCHASE PRICE OF THE PRODUCT TO WHICH SUCH LIABILITY RELATES. ANY ACTION FOR BREACH OF CONTRACT OR TORT MUST BE COMMENCED WITHIN ONE YEAR AFTER THE CAUSE OF ACTION HAS ACCRUED.

Nordfab specifically disclaims all liability for any and all costs, claims, demands, charges, expenses or other damages, either direct or indirect, incident to all property damages arising out of any cause of action based on strict liability.

INTELLECTUAL PROPERTY RIGHTS

The sale of Products or provision of services hereunder does not convey any express or implied license under any patent, copyright, trademark or other proprietary rights owned or controlled by Nordfab (beyond the use of the Product in the manner intended by Nordfab). Buyer agrees not to infringe, directly or indirectly, any patents of Nordfab or its affiliates through any combination or system incorporating a Product sold hereunder. In the event a Product is made or modified in accordance with Buyer's drawings, samples, manufacturing specifications, or the like, Buyer agrees to indemnify, defend, and hold Nordfab harmless from any and all damages, costs and expenses (including attorney's fees) related to any claim of patent infringement arising from such manufacture or modification. Buyer agrees, at Nordfab's sole discretion, to undertake the defense of such suit at its own expense.

COMPLIANCE WITH LAWS

Buyer shall comply with all laws and regulations applicable to the Products, including, but not limited to, all applicable import and export laws and regulations. Buyer has sole responsibility for obtaining any required export licenses. If the ultimate destination of the Products is outside of the United States, Buyer shall designate such country on its purchase order. In the event that Buyer purchases Products for export without so notifying Nordfab, Nordfab reserves the right to cancel the contract. Buyer will have sole liability and shall defend, indemnify and release Nordfab for any loss or damage (including without limitation, claims of governmental authorities) arising from the export from the United States or import into another country of such Products.

Without limiting the foregoing, Buyer represents and warrants to Nordfab that: (i) it is in compliance with all laws, ordinances, regulations and orders administered by the Office of Foreign Assets Control within the U.S. Department of the Treasury ("OFAC") or any other governmental authority imposing economic sanctions and trade embargoes ("Economic Sanctions Laws") against designated countries ("Embargoed Countries"), entities and persons (collectively, "Embargoed Targets"), and (ii) it is not itself an Embargoed Target or otherwise subject to any Economic Sanctions Law. Buyer shall comply with all Economic Sanctions Laws. Without limiting the generality of the foregoing, Buyer shall not (x) directly or indirectly export, re-export, transship, or otherwise deliver any Product (or any component or part thereof) to an Embargoed Target, or (y) broker, finance, or otherwise facilitate any transaction in violation of any Economic Sanctions Law.

RETURN GOODS AUTHORIZATION

To return Products to Nordfab, dealers must fill out an RGA Worksheet. The RGA can be requested from Nordfab's Sales Department. Each RGA must be filled out completely. Absolutely no shipments will be accepted by Nordfab without an RGA.

Shipments without RGAs will be returned to shipper at shipper's expense. No RGA will be issued for any order more than 90 days from the original ship date. If issued, an RGA is valid for 30 days from date of issue. Nordfab Products must be received at our designated return point factory within that 30 days in order for the dealer to receive credit.

Only restockable items may be returned to Nordfab. Restockable items are identified in Nordfab's Product Reference and on Nordfab's website. All other items are considered custom or special order and are nonreturnable. Nordfab reserves the right to limit return quantities. All returned goods must be shipped freight prepaid. All Nordfab ductwork must be shipped vertically with rolled edge down to avoid incurring out-of-round damage during shipping. There is a 25% restocking charge for all returned goods. All components must arrive in "as-new" sellable condition. Damage and "white rust" occur over time at job sites, which may cause the items to not be sellable. Final determination of sell ability will be determined by Nordfab, at its sole discretion.

Take advantage of our online resources at www.nordfab.com:

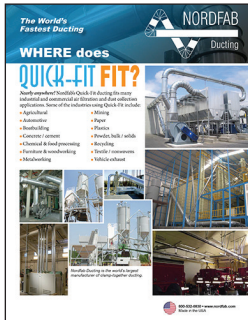

WHERE does QUICK-FIT FIT?

Quick-Fit is the world's fastest ducting. It's ducting that's easy to install, easy to use, and easy to maintain. It's ducting that's designed for the most demanding applications. Quick-Fit is available in a variety of materials and finishes to meet your needs.

- Machining
- Welding
- Chemical & food processing
- Textiles & bookbinding
- Machining
- Plastics
- Medical
- Chemical & food processing
- Textiles & bookbinding
- Machining

Applications



Why Use Nordfab Ducting In Your Woodworking Shop?

A Proven Application
Nordfab ducting is the most popular choice for woodworkers because of its ease of installation and maintenance. It's ducting that's designed for the most demanding applications. Quick-Fit is available in a variety of materials and finishes to meet your needs.

- Easy to install
- Easy to use
- Easy to maintain
- Durable
- Available in a variety of materials and finishes

Applications Brochures



QUICK-FIT Quick-Fit Clamp Together Ducting

- Easy to install
- Easy to use
- Easy to maintain
- Durable
- Available in a variety of materials and finishes

Clamdown Sheet

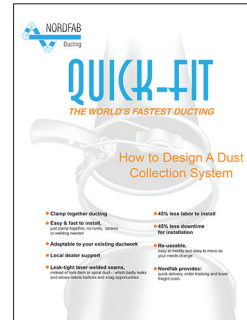

QUICK-FIT THE WORLD'S FASTEST DUCTING

How to Design A Dust Collection System

- Clean together ducting
- Easy to install
- Easy to use
- Easy to maintain
- Durable
- Available in a variety of materials and finishes

How to Design a System



Oil Mist & Cutting Fluid Duct System

Advantages:
• Easy to install

Applications:
• Machining

Oil Mist System

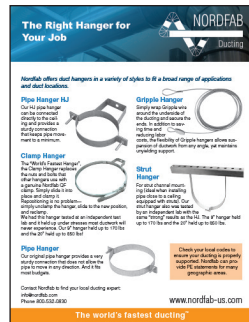

The Right Hanger for Your Job

Nordfab offers dust hangers in a variety of styles to fit a broad range of applications and dust locations.

- Pipe Hanger
- Clamp Hanger
- Pipe Hanger

Pipe Hangers



Nordfab Drawing Service Information Sheet (Rev 4/1)

Company Name: _____
Address: _____
Phone: _____ Fax: _____
Contact Person: _____ Email: _____

General Information:
A. What kind of material is being collected?
B. What is the dust collection system?
C. What is the dust collector?
D. What is your dust collector fan?
E. What is your dust collector fan speed?
F. What is your dust collector fan voltage?
G. What is your dust collector fan frequency?
H. What is your dust collector fan phase?
I. Please indicate where the duct is located on the drawing page. If you are not indicating a duct location, Nordfab will select a duct and any changes to that duct will be at your expense.
J. Any other additional comments.

Nordfab Drawing Service



Nordfab Ducting Helps You Make All The Right Connections

Manifold Specification Sheet

Name: _____
Address: _____
Phone: _____
Email: _____

Please provide the following information when ordering a dust collection manifold:
• Manifold location
• Manifold height
• Manifold diameter
• Manifold material

Manifold Spec. Sheet

Your Local Ducting Expert:

